

IDENTITY

created by | architecture
infrastructure
people

by
Illia Mitalov
Johanna Prax
levgeniia Vietrova

Johanna Prax 1226768
levghienii Vietrova 1429937
Illia Mitalov 1635250



Städtebau TU Wien

LANDSCAPE TU WIEN



bmwfw

oead

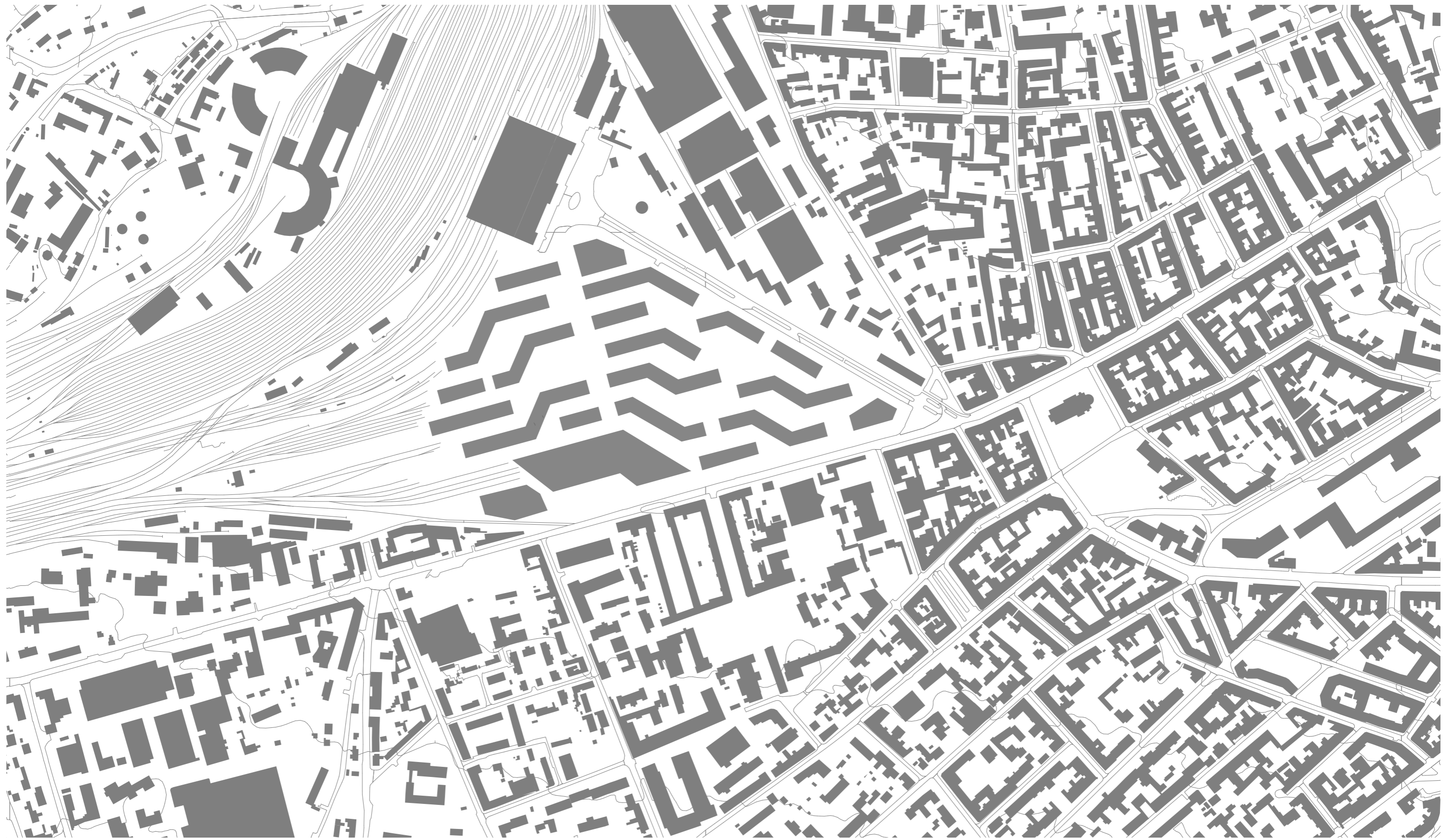
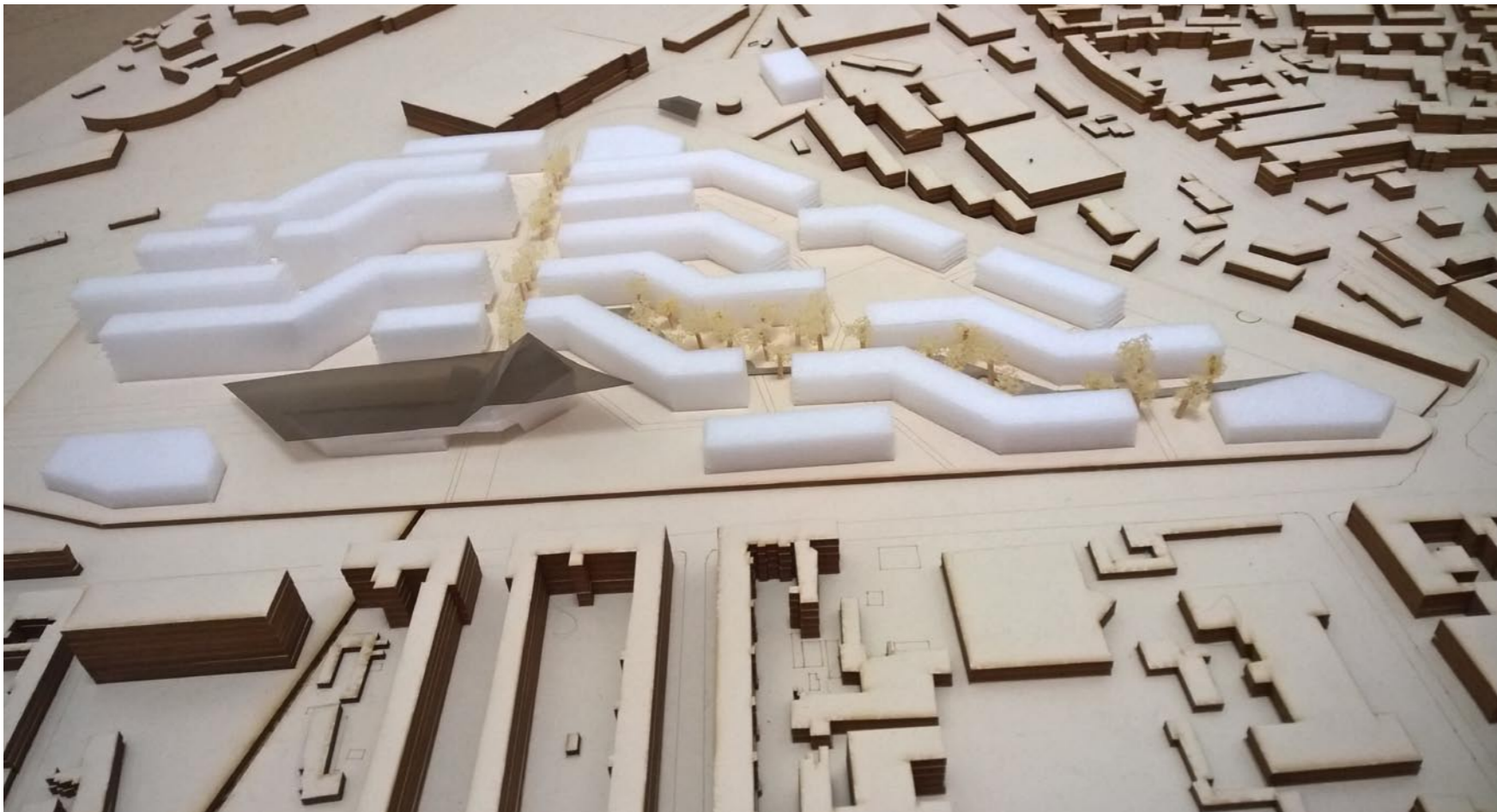

figure ground plan







Central Railway Station Lviv

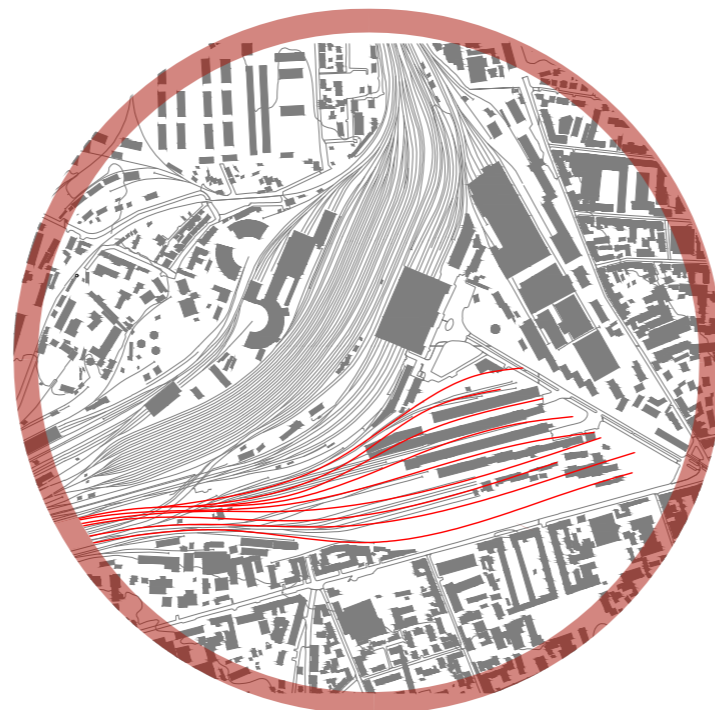

follows the form of the railway tracks

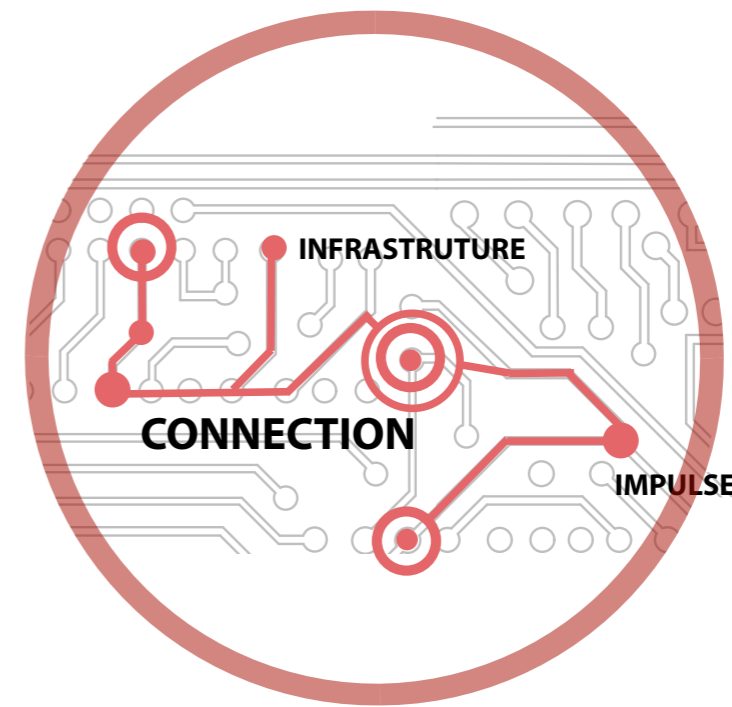

transformation to a vibrant area with multiple connections, impulses and infrastructure

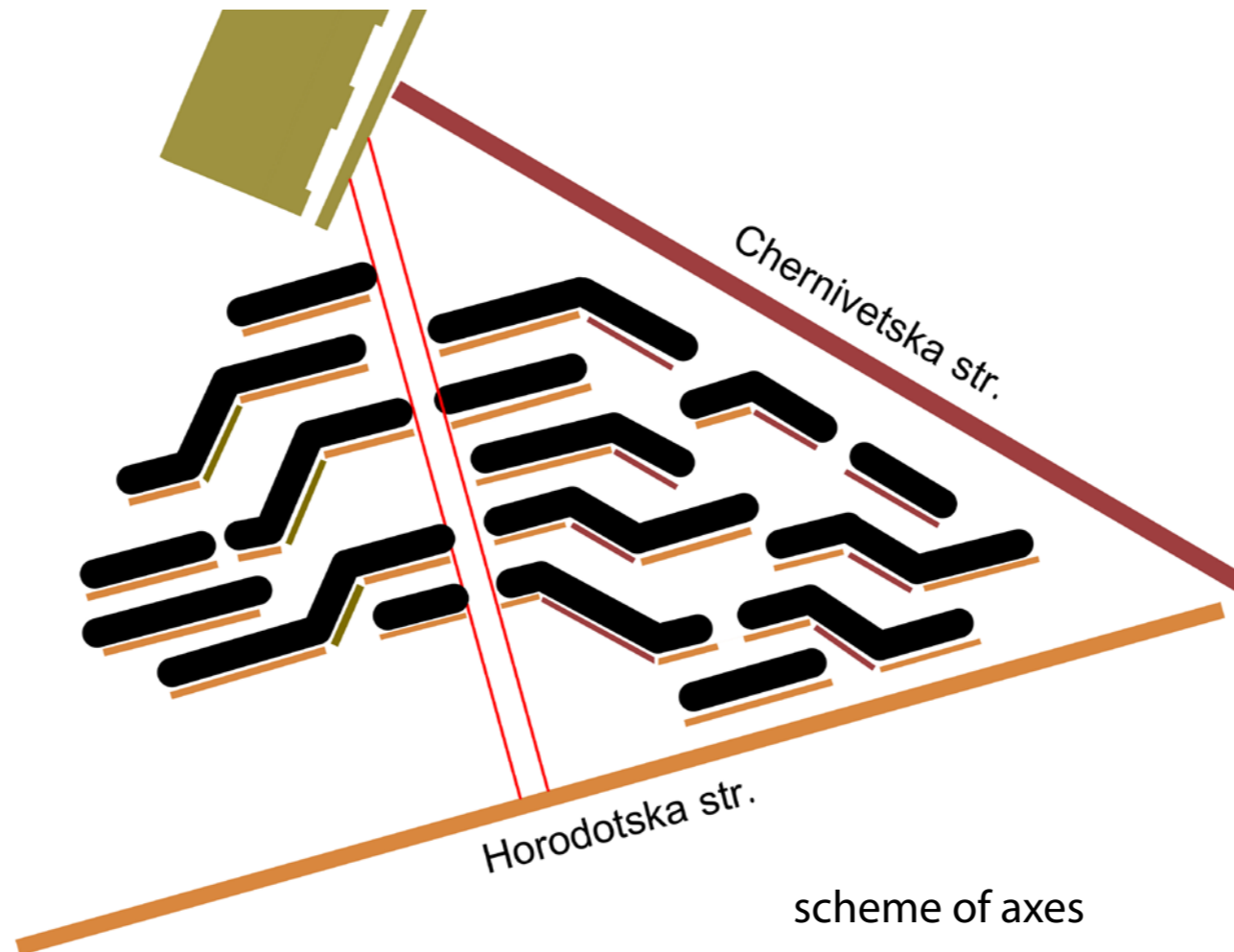

scheme of axes



Facts:

- density: 1.6
- 1200 flats/ 2800 residents
- 7000 employees
- 27000 passengers per day at the Transport HUB

Masterplan



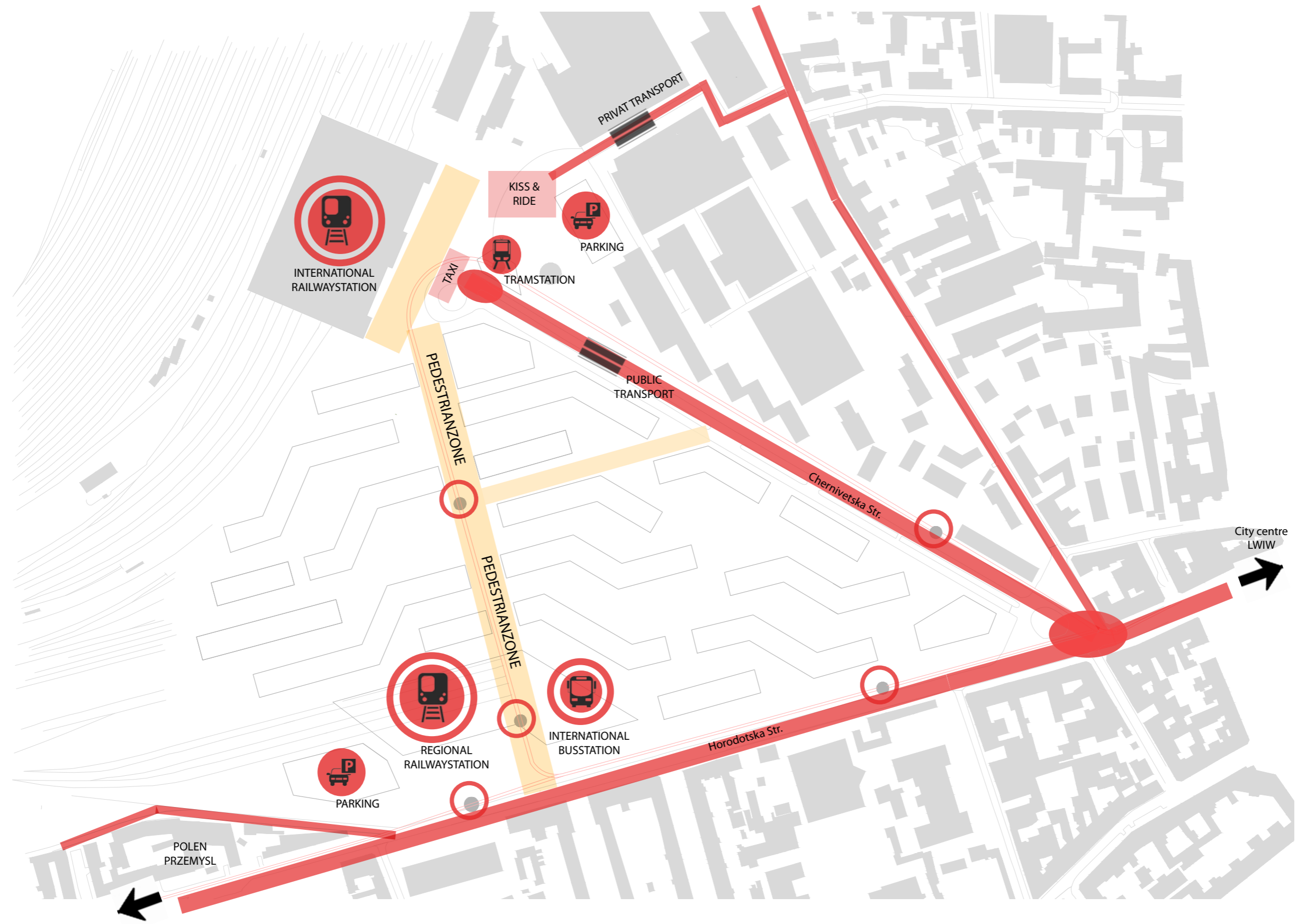

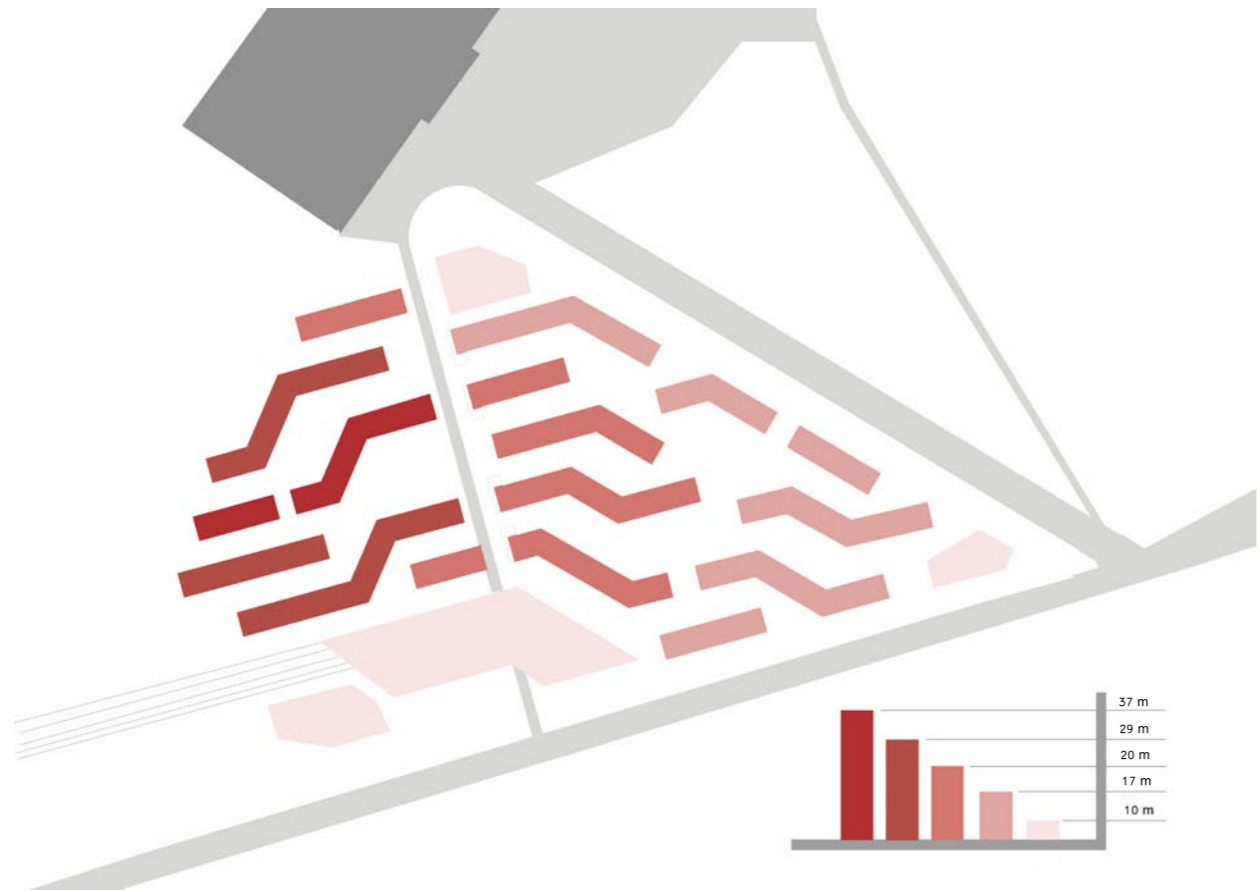

diagram of building heights

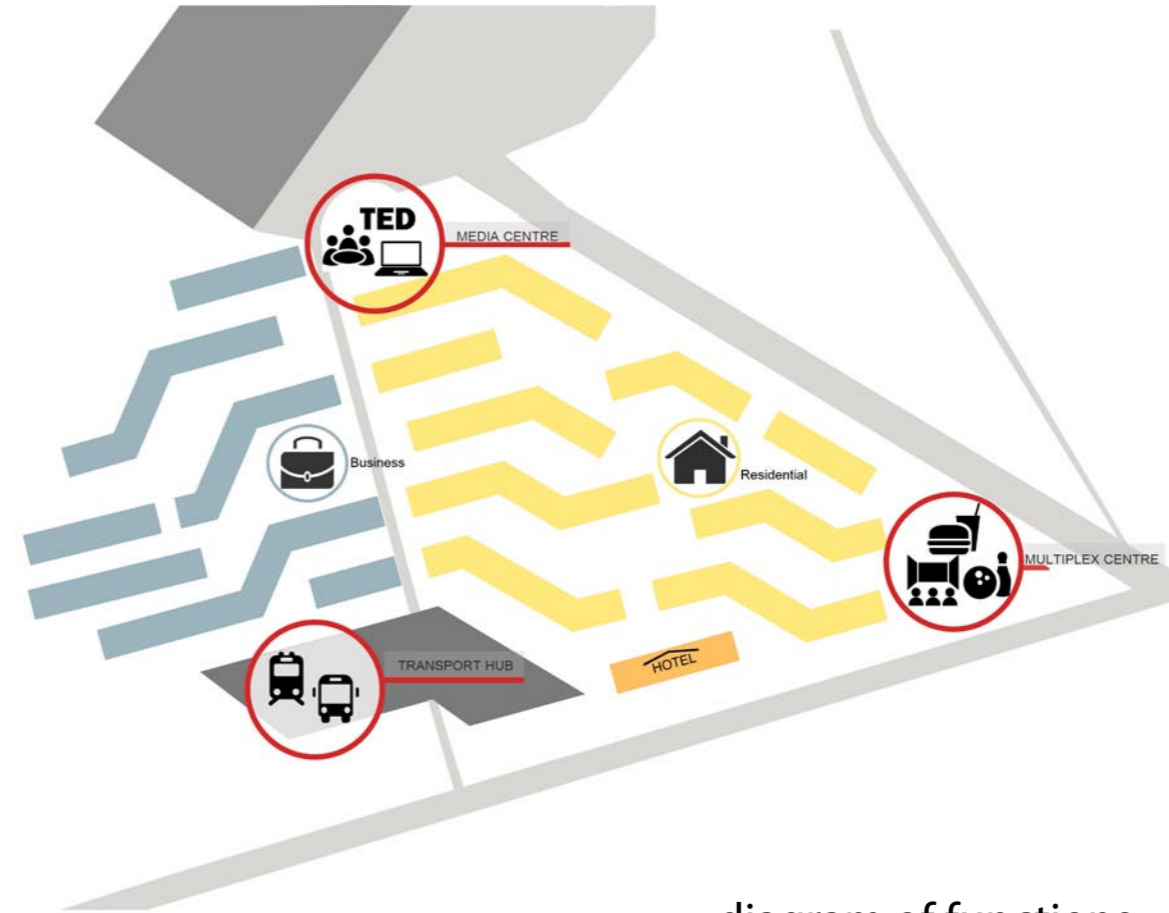
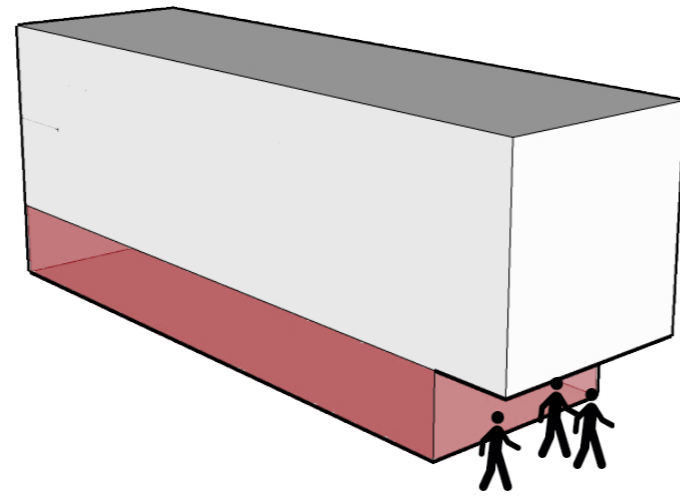

diagram of functions



plan of accesses through out the area





BUSINESS-MODUL boulevard
 groundfloor : shopping zone
 facade: protruding

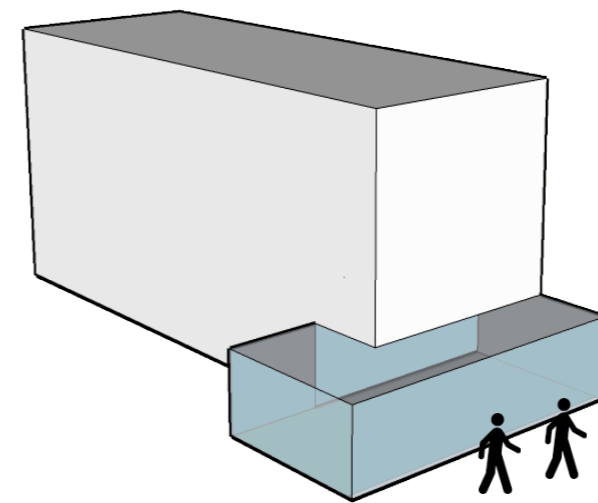

LIVING-MODUL boulevard
 groundfloor : additional cube for shops
 facade: recessed

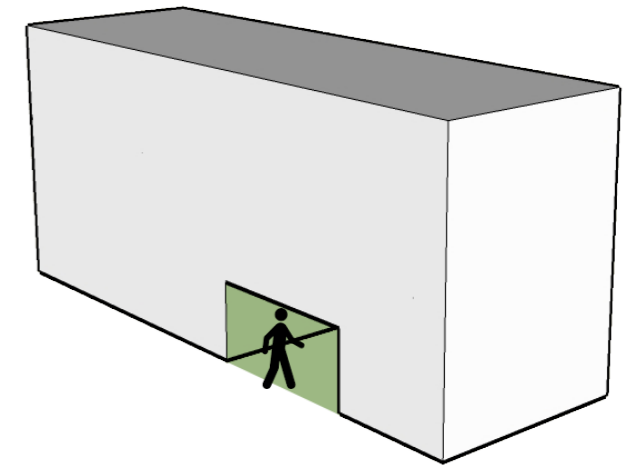

MIDDLE-MODUL
 groundfloor : additional passages

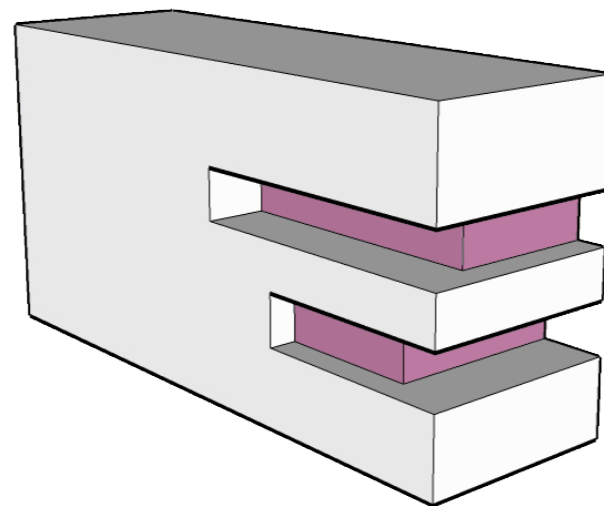

BUSINESS-MODUL front
 front-facade: cut outs for terraces

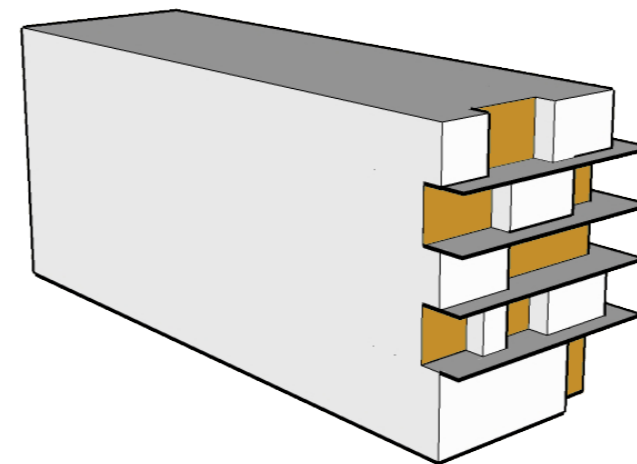

LIVING-MODUL front
 front-facade: cut outs for bigger terraces

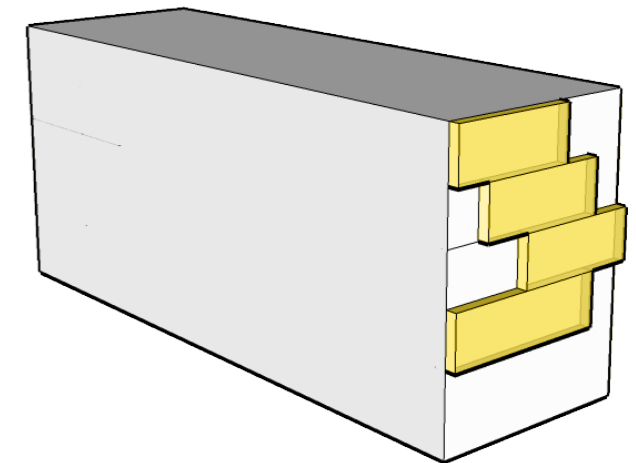

SPECIAL-MODUL boulevard
 front of the facade: illuminated

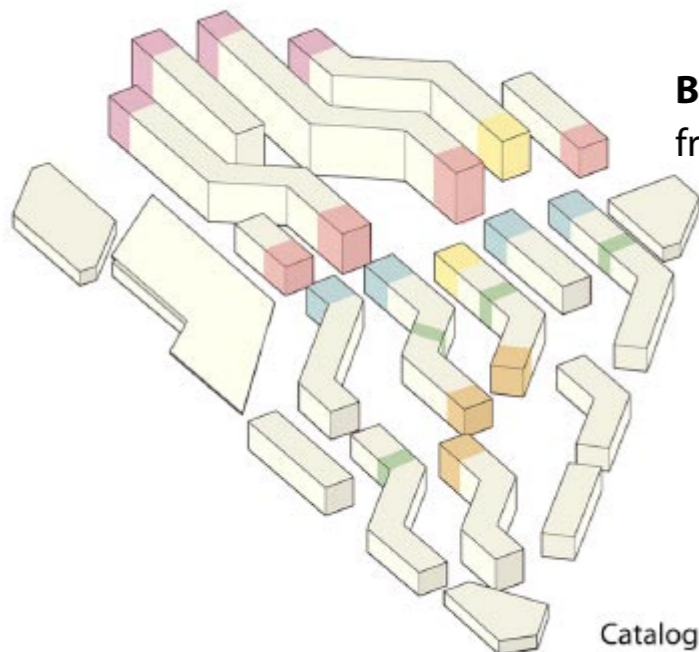

Catalogue of moduls

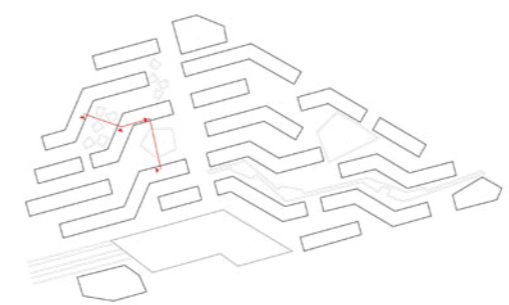
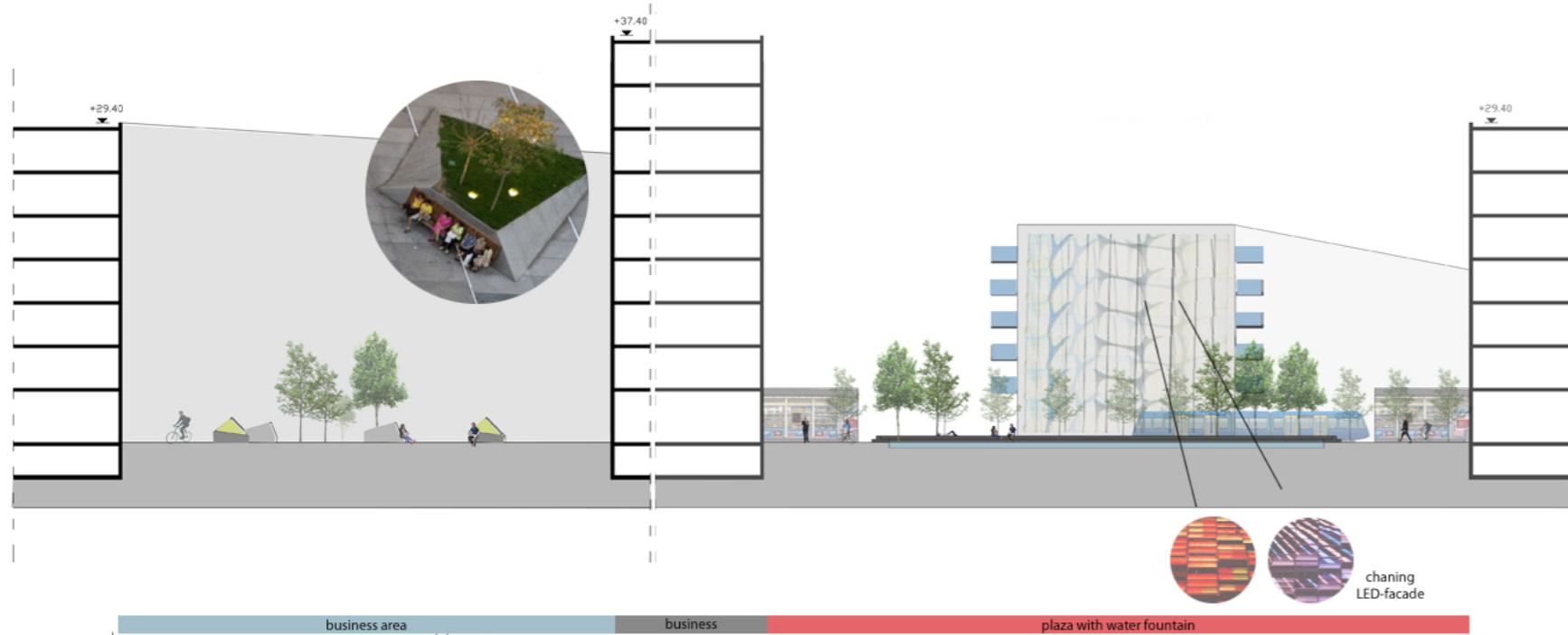
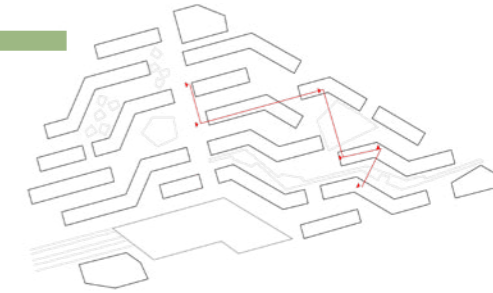
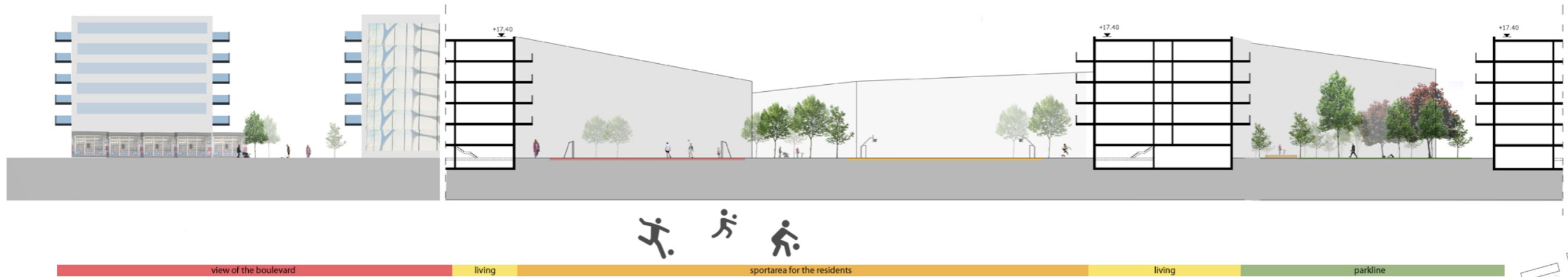
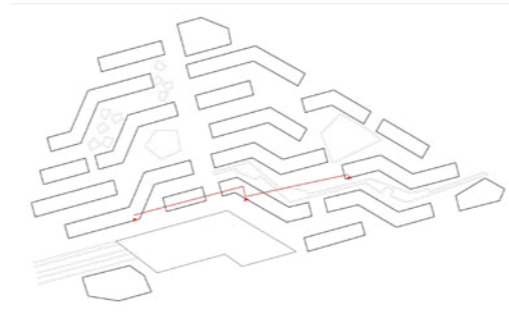
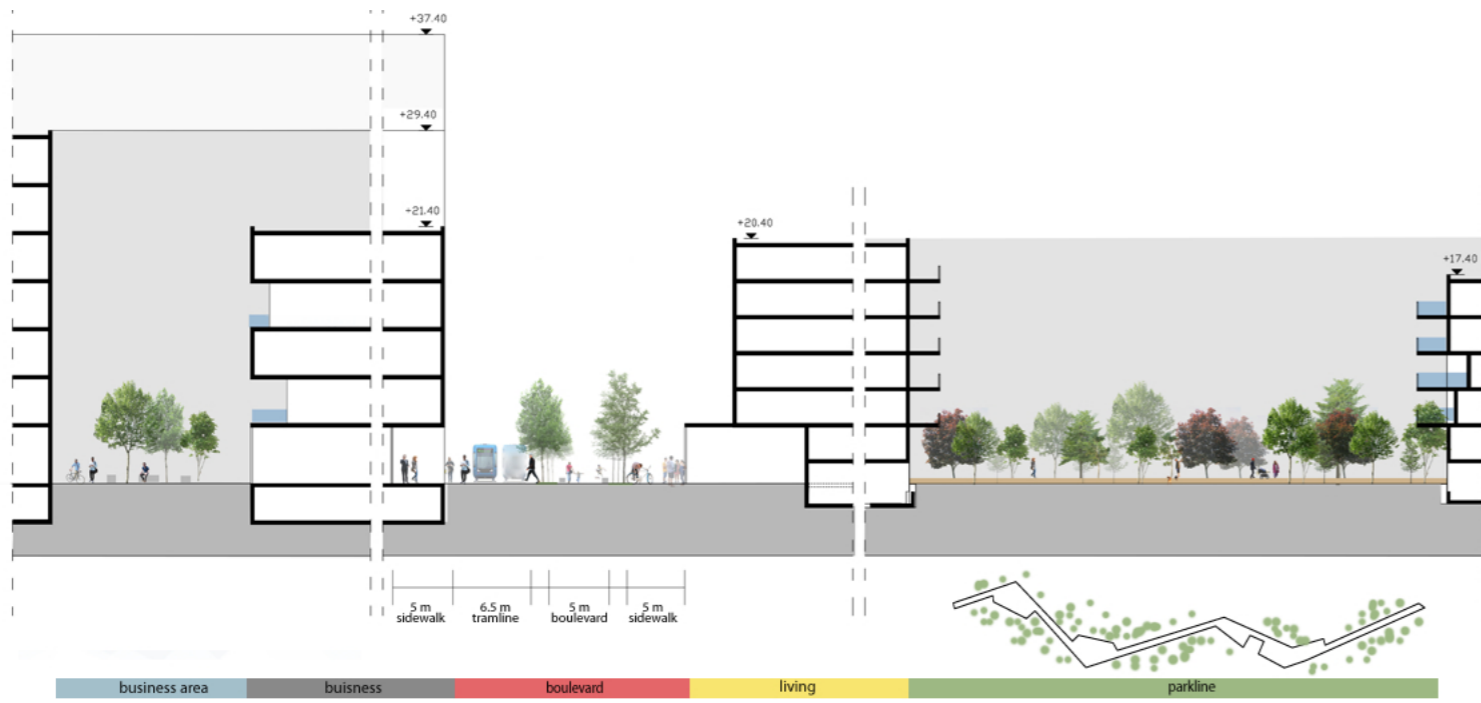

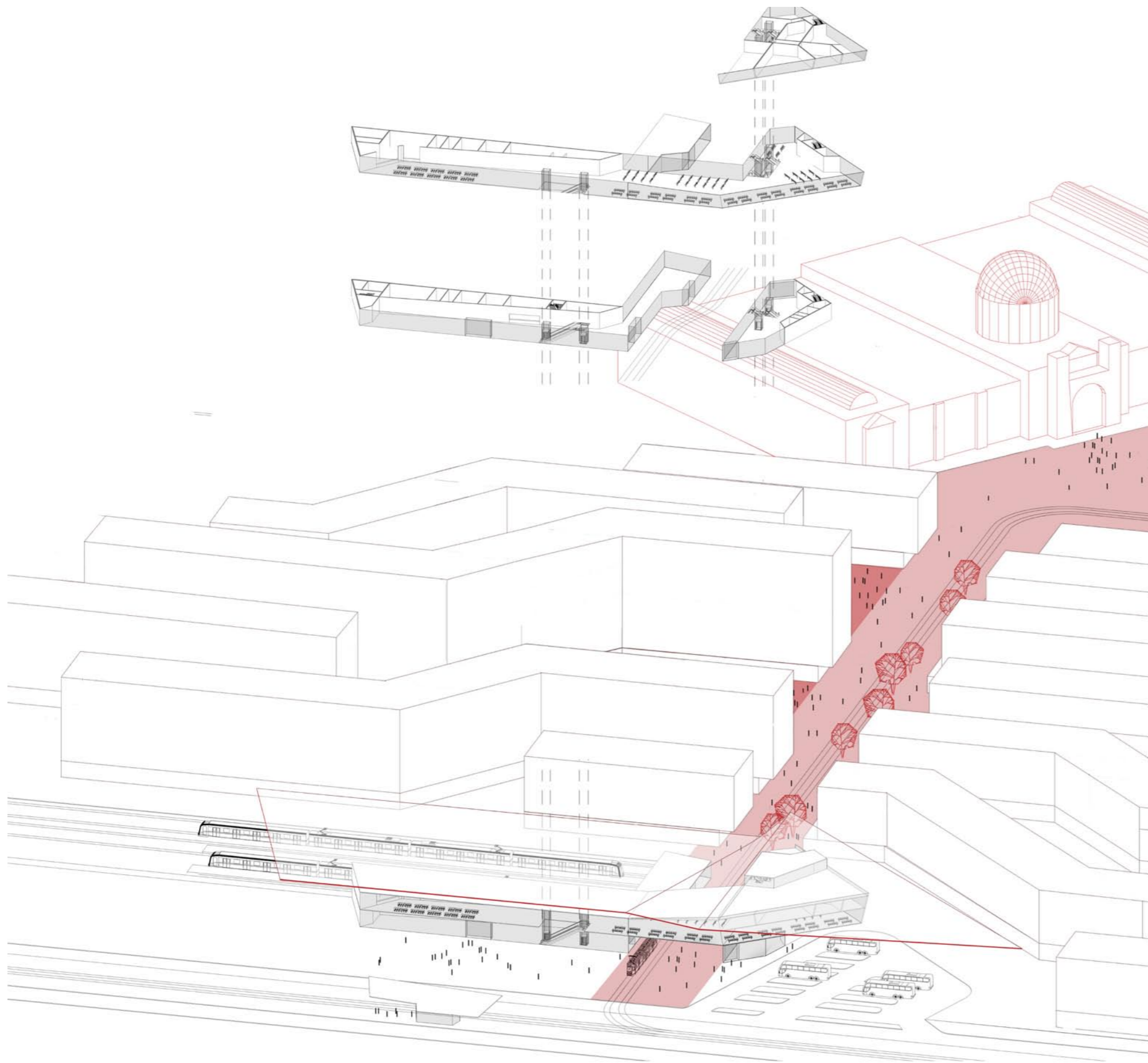

Axonometry of the Transport HUB

view of the boulevard



view of the park line

