

(re) - Movement

re-interpreting

re-inforcing

re-defining

Lea Fröhlinger
Nina Grünefeldt

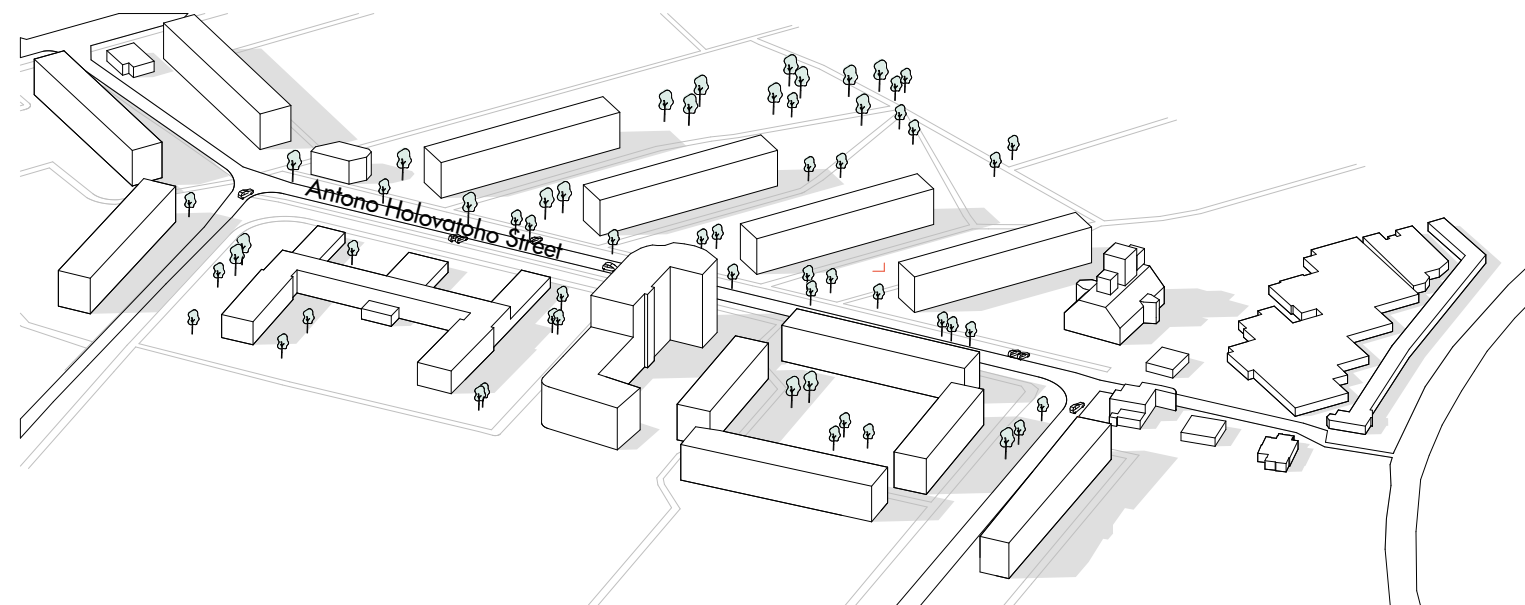

focal area

statement

An essential characteristic of our focal area is its heterogeneity: all typologies of Vyhoskohos are therein present. Every typology has its own free space setting, generates its own atmosphere and differs in its content. We see great potential in this variety and diversity - essential for people to find direction and guidance in urban space. However, we view the condition of individual buildings and space situations, or more specifically, how they are utilised, as critical.

These typologies with their characteristic qualities are attached to an axis and operate like a system of connected gearwheels. There are large, small, colourful, gray, rusty, old and fragile gearwheels. Nevertheless, every single one is crucial to interlock into each other in order to maintain movement.

It is our goal to enhance, define or reinterpret individual spatial situations. As an abstraction to the gearwheels system, interventions will be implemented in urban space that will establish qualities in the form of both existing as well as missing structures. Thereby, not only will functioning gearwheels be optimised, but also flawed gearwheels will be developed and intensified.

Currently, existing but undefined open spaces will be given definition, residents' private living space will be expanded, and public areas will be improved and points of orientation will be strengthened. A mixture of work, living and recreation, will allow inhabitants to meet and interact socially.

metaphor gearwheels

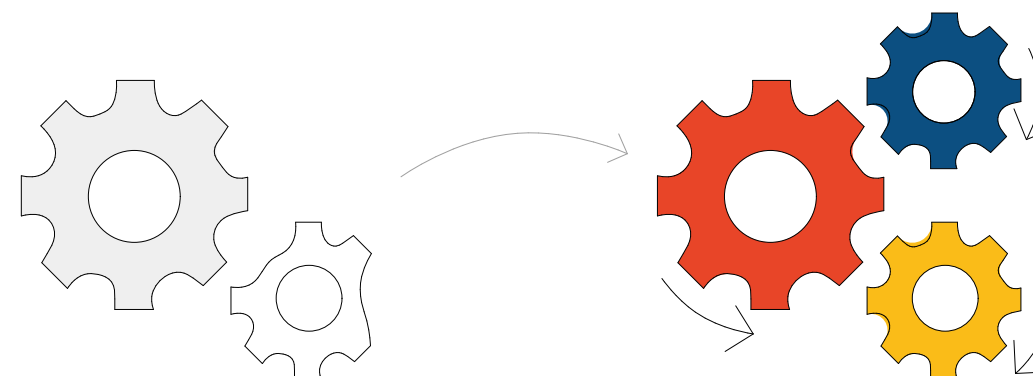

Optimize major gearwheels, develop and intensify flawed gearwheels and add new gearwheels to interlock into each other: enable movement

analysis: typology Vhoskovo pertaining to our focal area

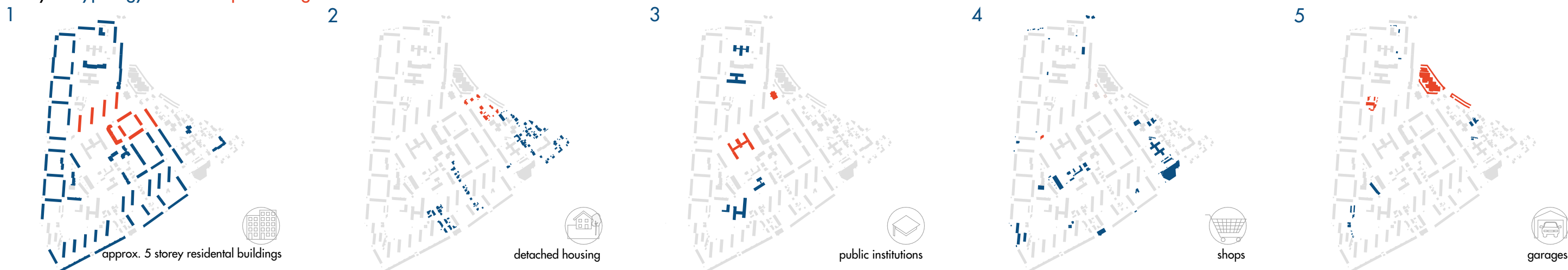

analysis and interpretation

space setting of the typologies in context

legend

gearwheel colours

living space



undefined space



public space



gearwheel shapes

problem: **reinterpretation**
establishing missing structures



challenge: **redefining**
optimizing existing structures



potential: **reinforcing**
strengthening qualities of existing structures



gearwheel sizes

high intervention



intervention



low intervention



buildings in rows 4

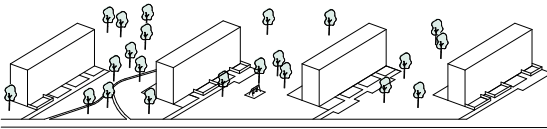

4 residential buildings, approx. 45° to the street; between "forest" and street in which the open space alternately opens and closes

undefined space



minimal living space



no accessibility

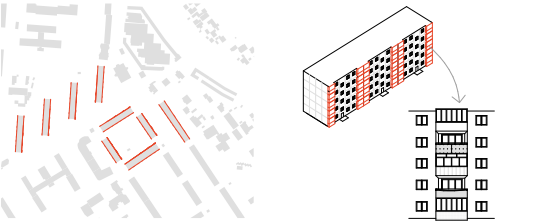

inhabitants' personal initiative: individual extension of living space through badly insulated bay windows or balconies used mainly for storage

shops 1

two one storey shops; small supermarket and small café; local supply; point of many sightlines

landmark



Axis Anton Holovatoho 3

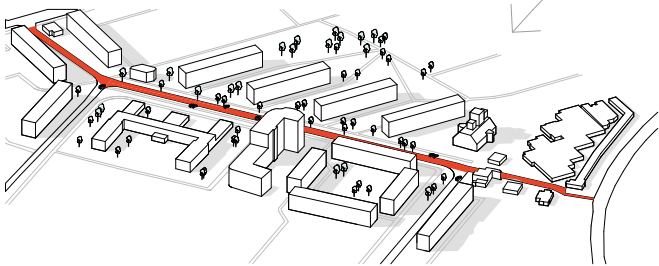

important traffic axis; enlivened by pedestrians; green space between road and sidewalk

busy road, dangerous crossing



connection of gearwheels: prerequisite for interlocking



church 6

the church is one of the newest buildings in the area (2011); it is surrounded by a wall that separates it from the rest of the area; the open space is mostly used as a parking space and offers no residential qualities

open space as parking lot



landmark

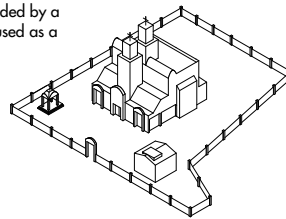

figure ground plan 1:2000



garages 7

largest garage complex of the area (10.000m²); one storey;
use: parking area, workshops;
separation: massive rear wall, entrance barriers;
between church and railway

space-consuming, dilapidated garage facility



train station

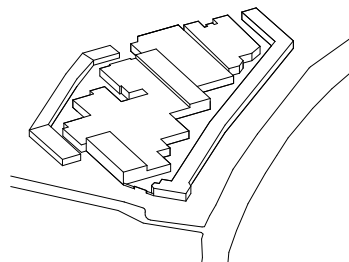

railway crossing 8

inhabitants' personal initiative: crossing the railway tracks on very steep, run-down stairs

dangerous crossing of the railway tracks

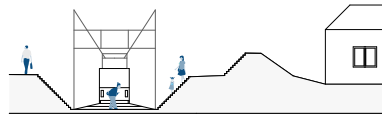

courtyards

four residential buildings form a courtyard; the constellation of the buildings defines the open space more strongly than the open buildings in a row

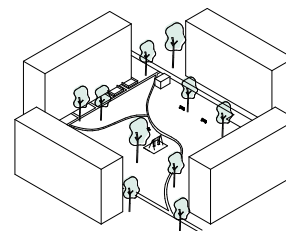

semi-public space



minimal living space



no accessibility



inhabitants' personal initiative: green space with improvised uses: gardening, clotheslines, worn paths, fences, attachments

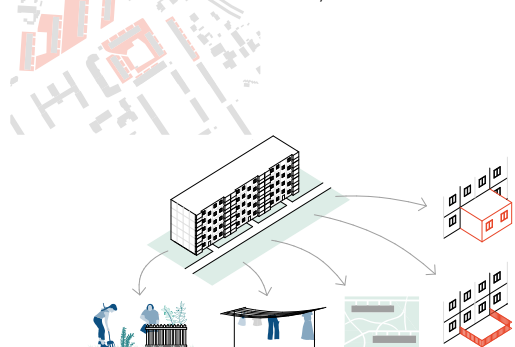

school of Mathematics and Physics 2

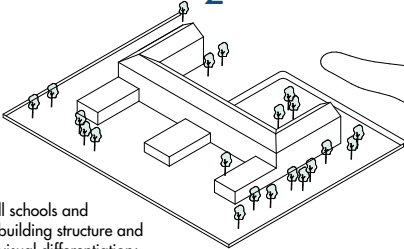

separated by fence; all schools and kindergartens similar building structure and open space situation: visual differentiation; behind school: large open space for football...

residential building 5

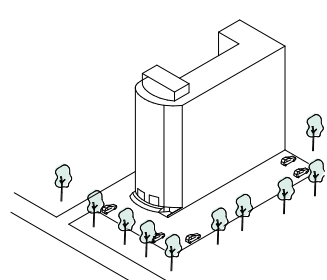

approx. 1990s; with 12 storeys it is the tallest building; it differs both visually and in terms of content from the other blocks of flats

landmark



public ground floor



Goals enable movement of axis

goals: enable movement of axis

1

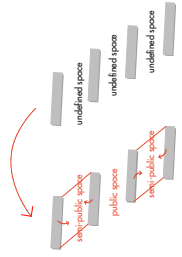

zones: creating semi-public spaces

2

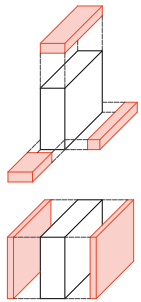

extend private space

3

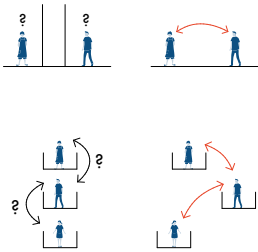

improving and amplifying public spaces: providing social interaction and communication

4

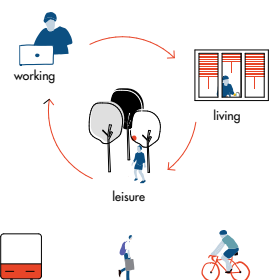

mix of functions; activation of mobility

5

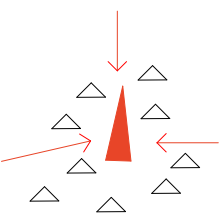

supporting the orientation: landmarks to provide sightlines

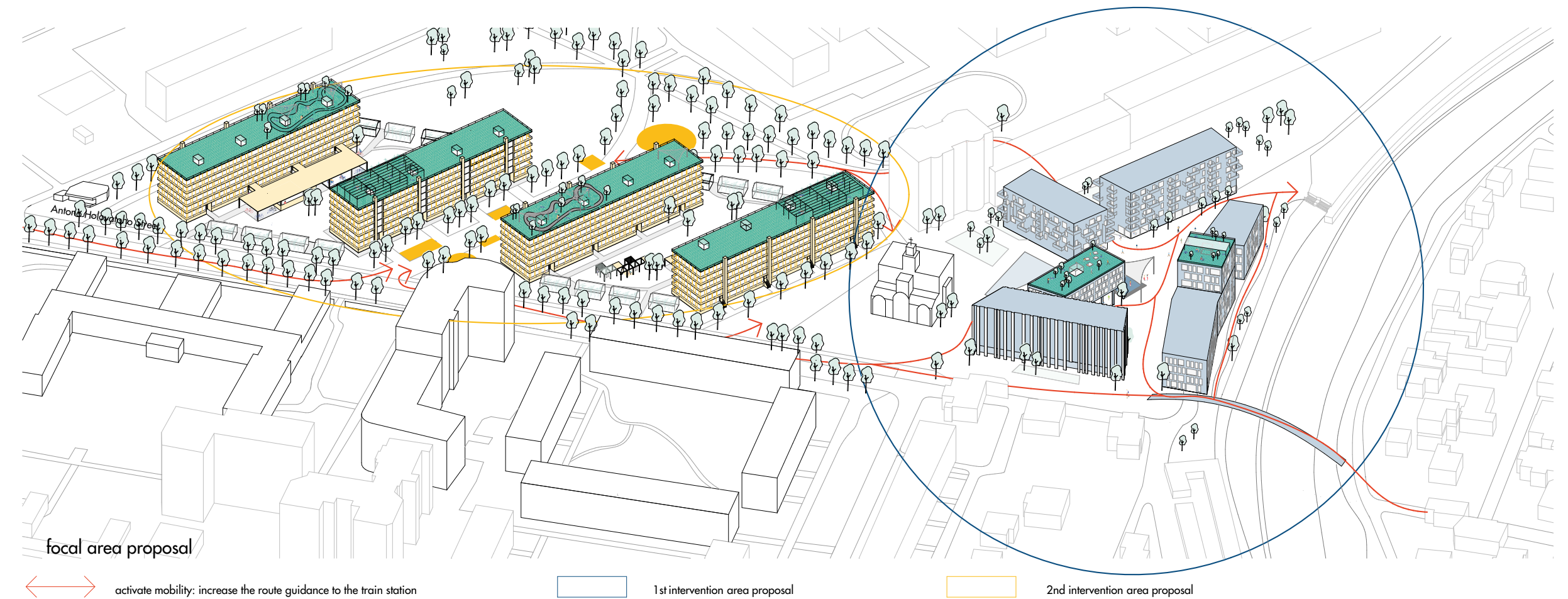
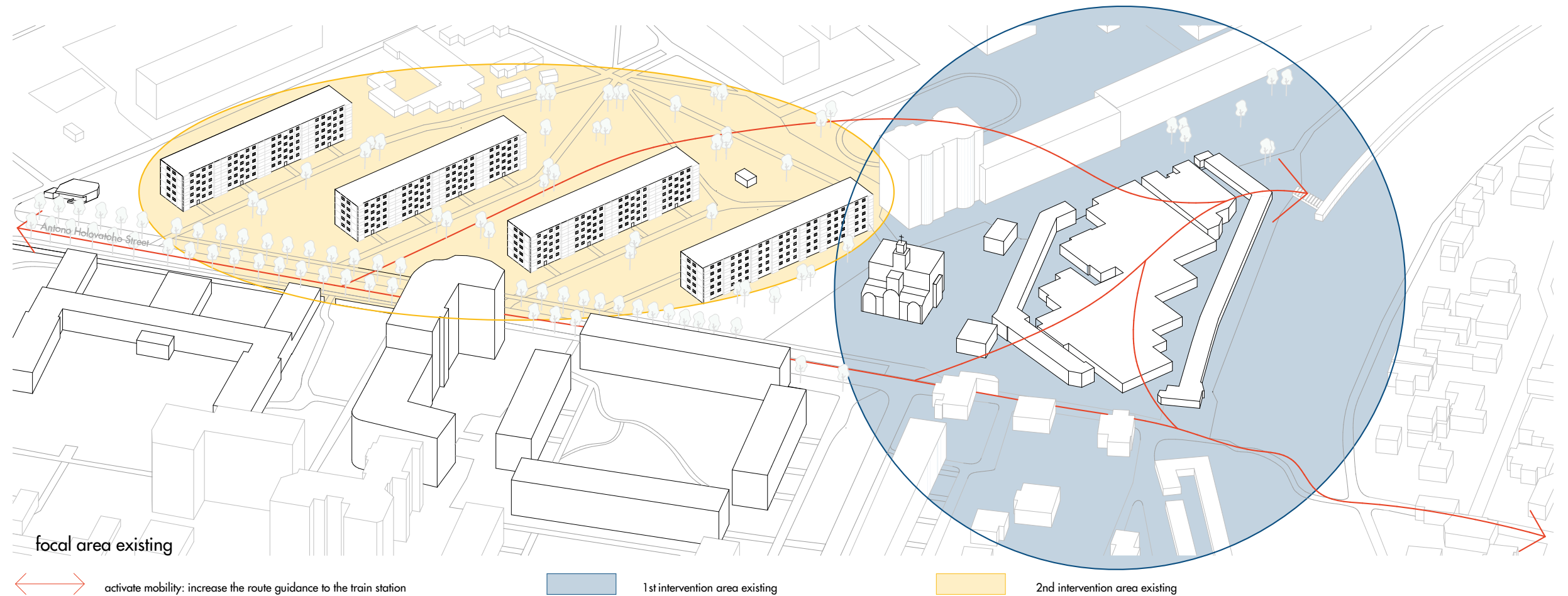

1st intervention area

existing

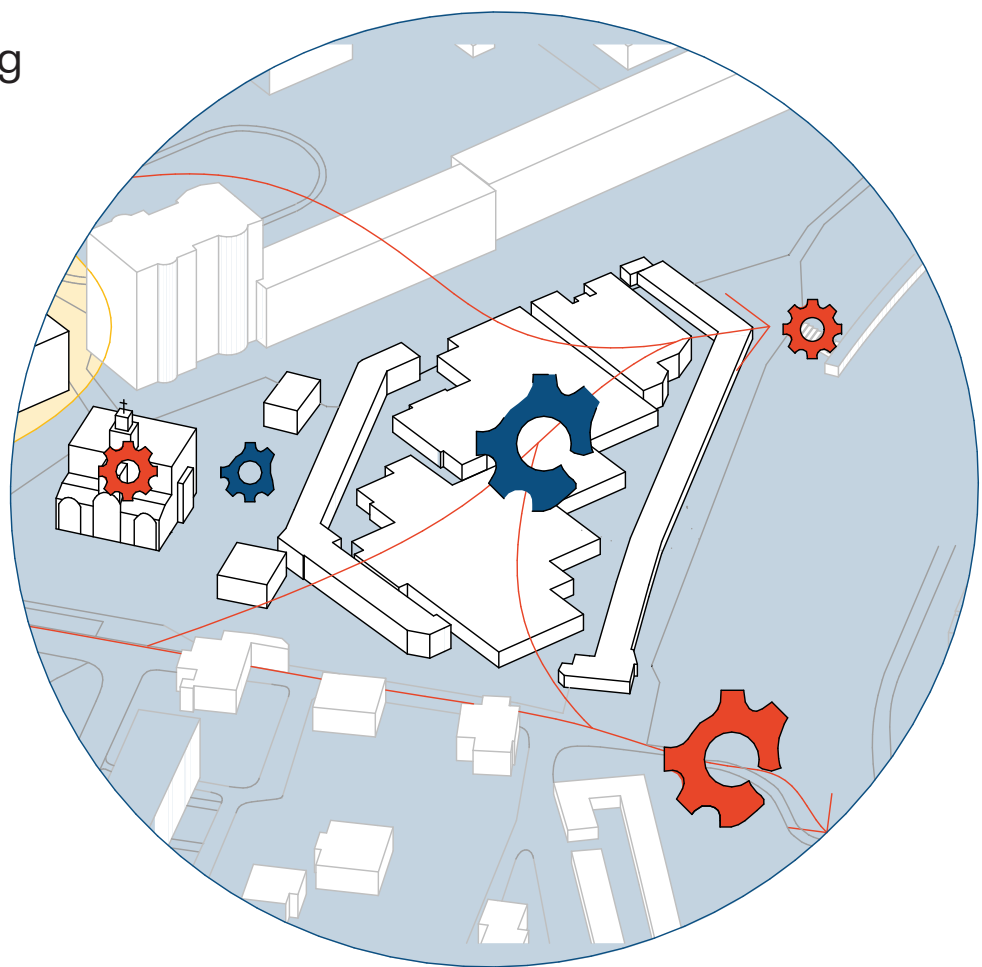

proposal

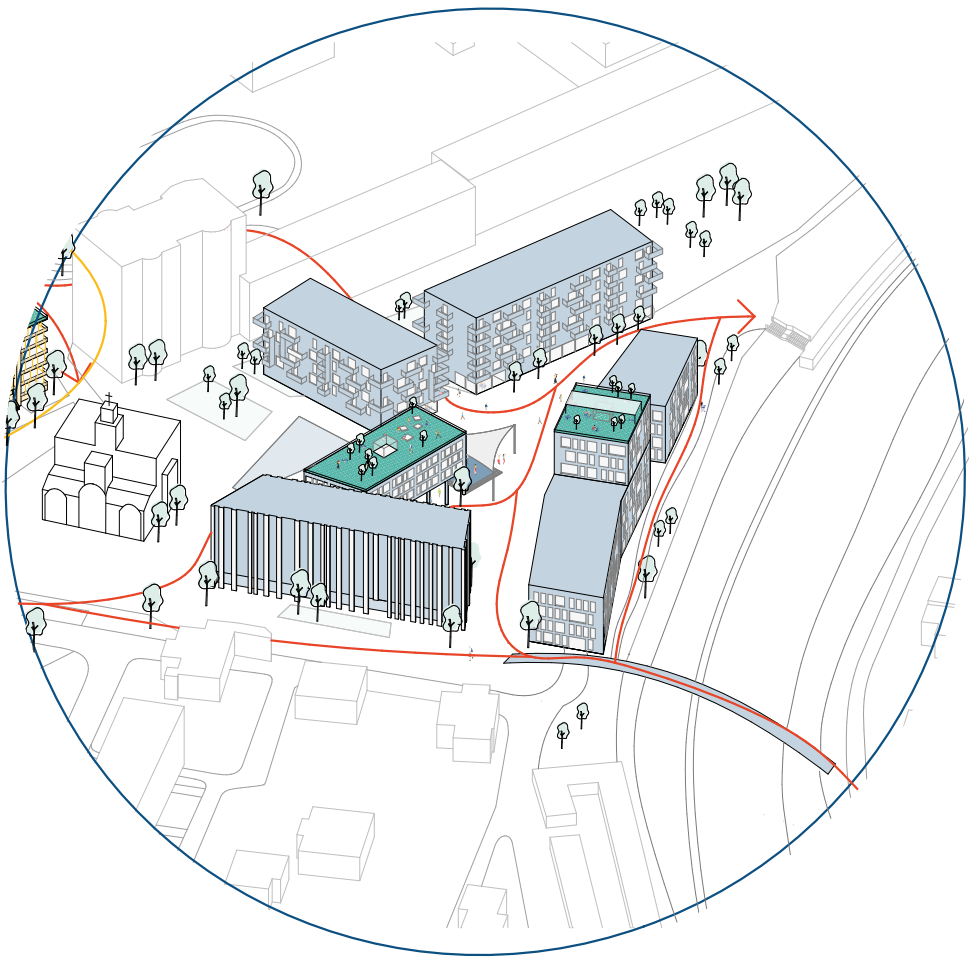

space-consuming, dilapidated garage facility



dangerous crossing of the railway tracks



open space as parking lot



landmark



mobility

reinterpretation

reinterpretation

redefining

reinforcing

reinforcing

replace parking lots and workshops: adding new functions

bridge: providing a safe connection to the railway station

new public space: social interaction and communication

new significance

increase rout guidance to the train station



public space



density



zones



route guidance



variety



different functions



sight lines



mobility

1st intervention area

process intervention

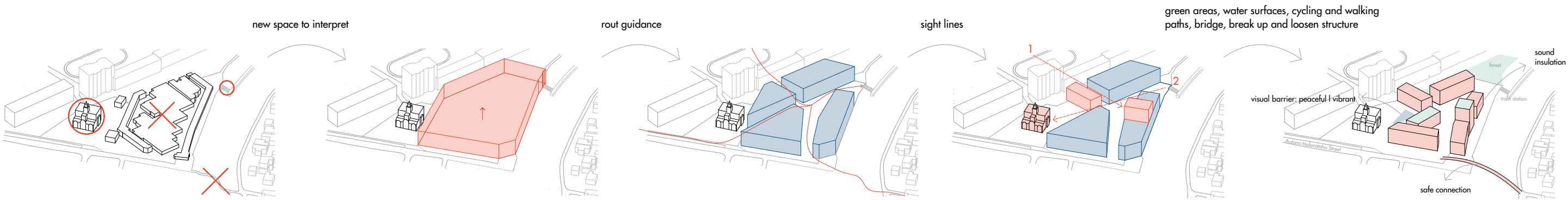

building use

use of ground floor

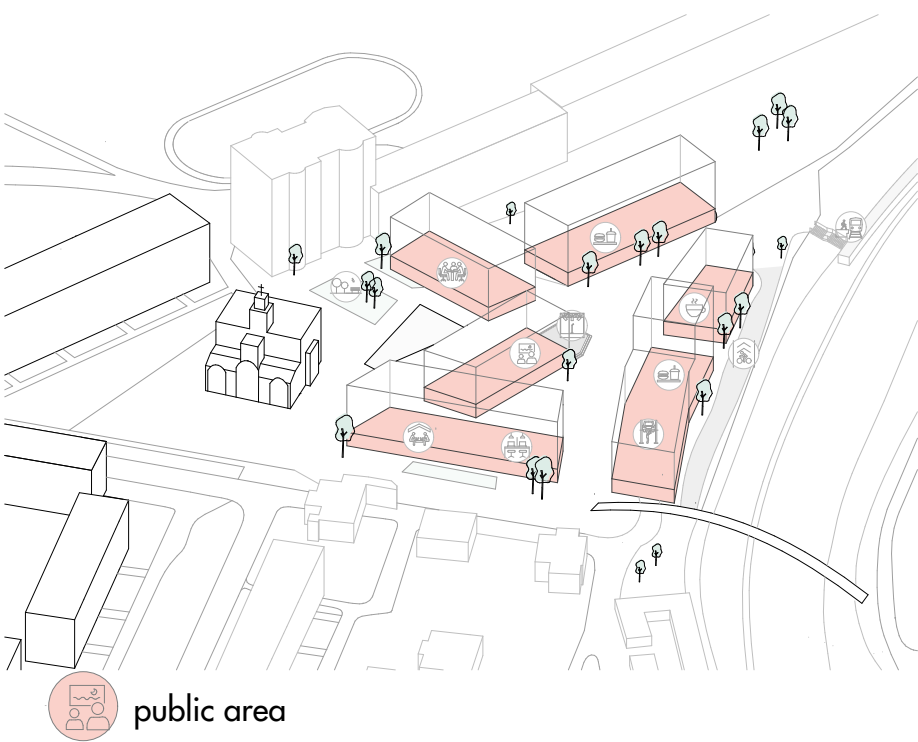

- | | |
|---|---|
|  youth centre culture centre |  office |
|  stage culture center |  common room |
|  cafe |  train station |
|  cycle path |  green area |
|  restaurant |  co-working area |
|  workshops | |

use of building complex

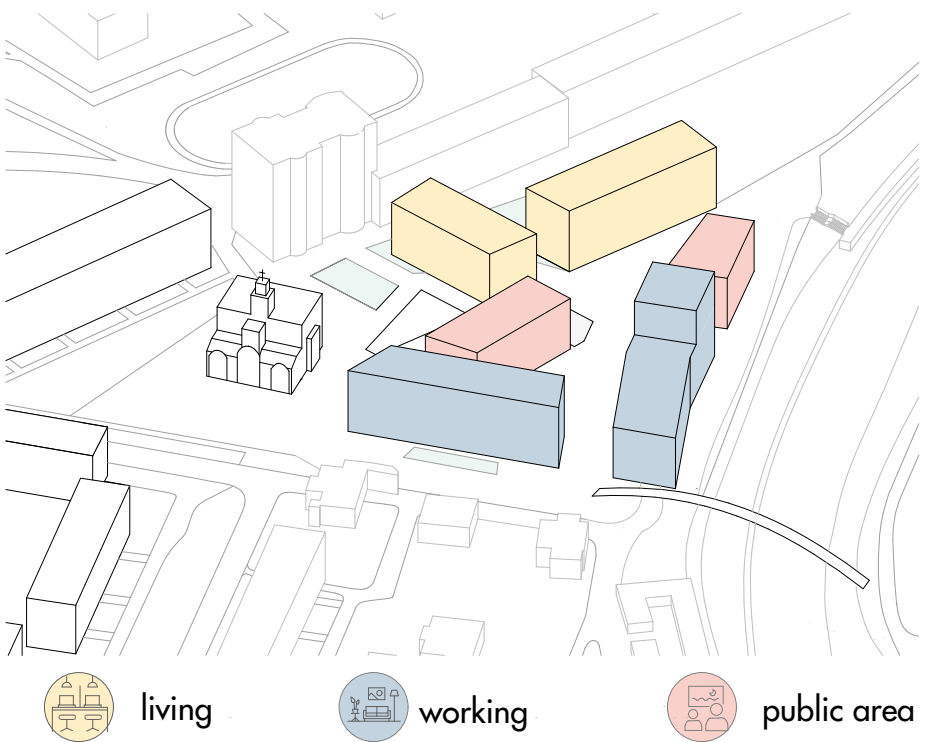

1st intervention area

water feature

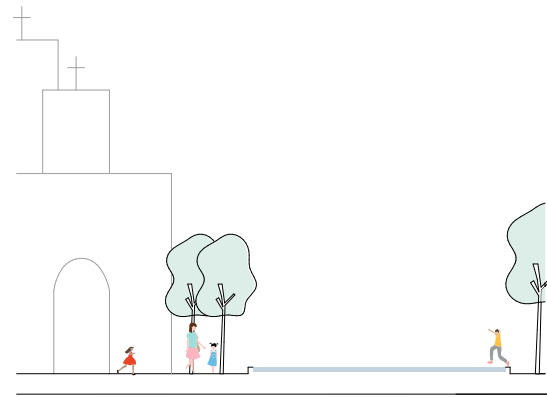

for a enjoyable mikro-klimat and physical comfort in the urban area

stage

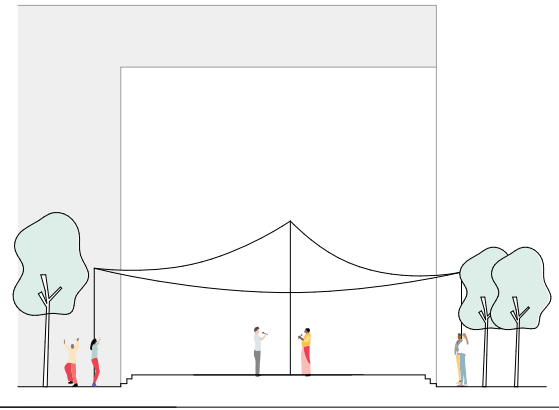

strengthening the cultural infrastructure

rooftop-bar

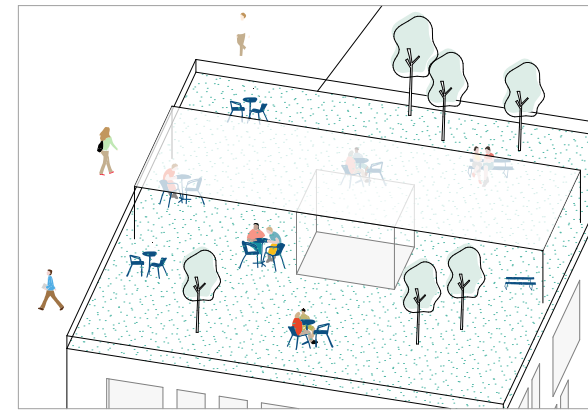

tower: wide view over the whole square

youth chill-out

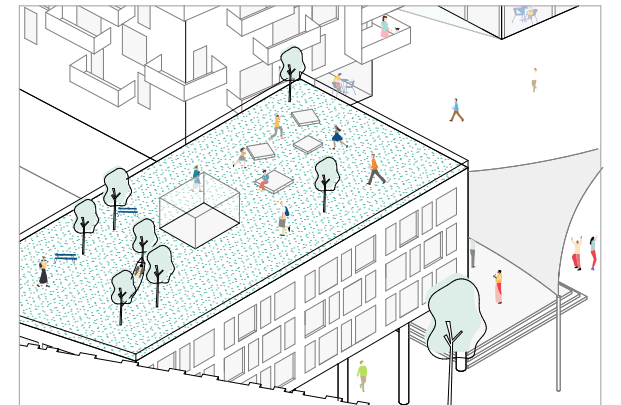

space for youth: being among themselves

Perspective: site line 1

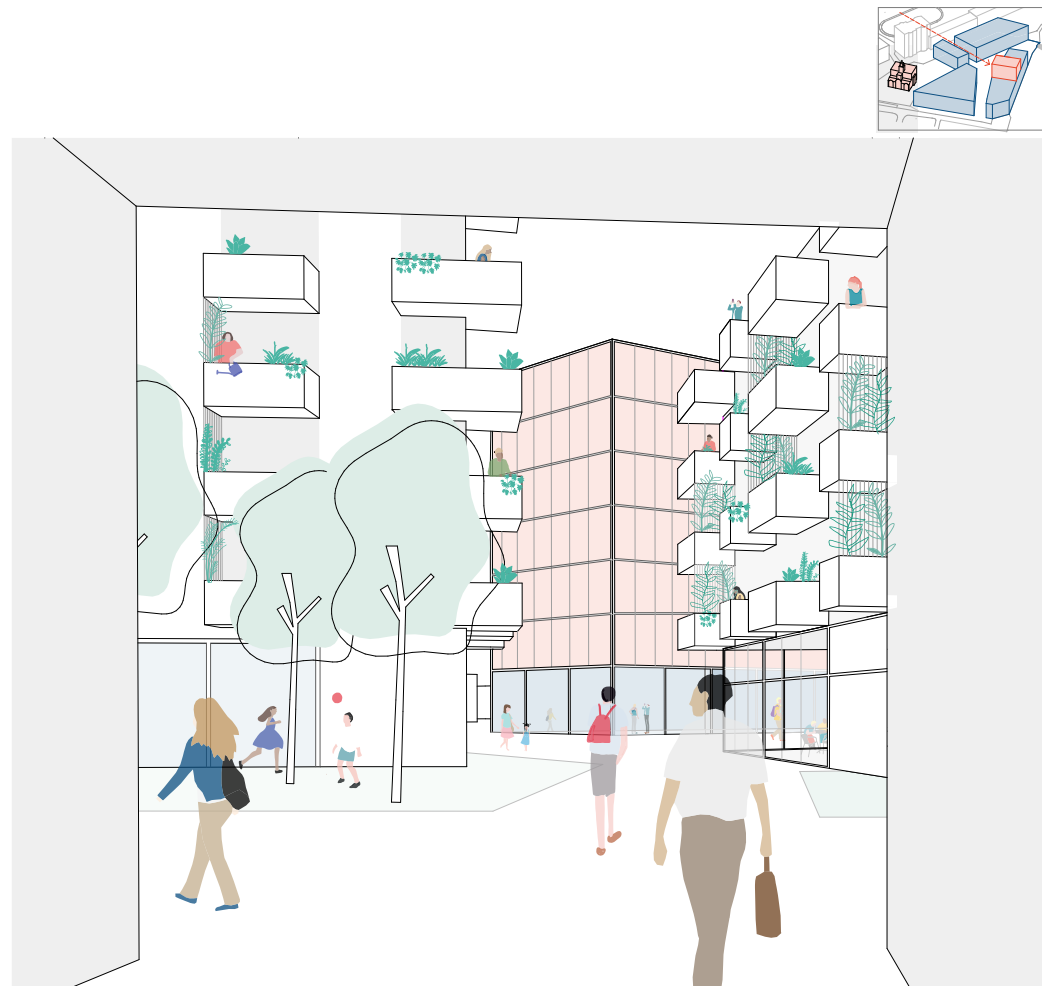

Perspective: site line 2



ground floor | 1st intervention area



route guidance



sight lines



possibilities of crossing

2nd Intervention area

existing

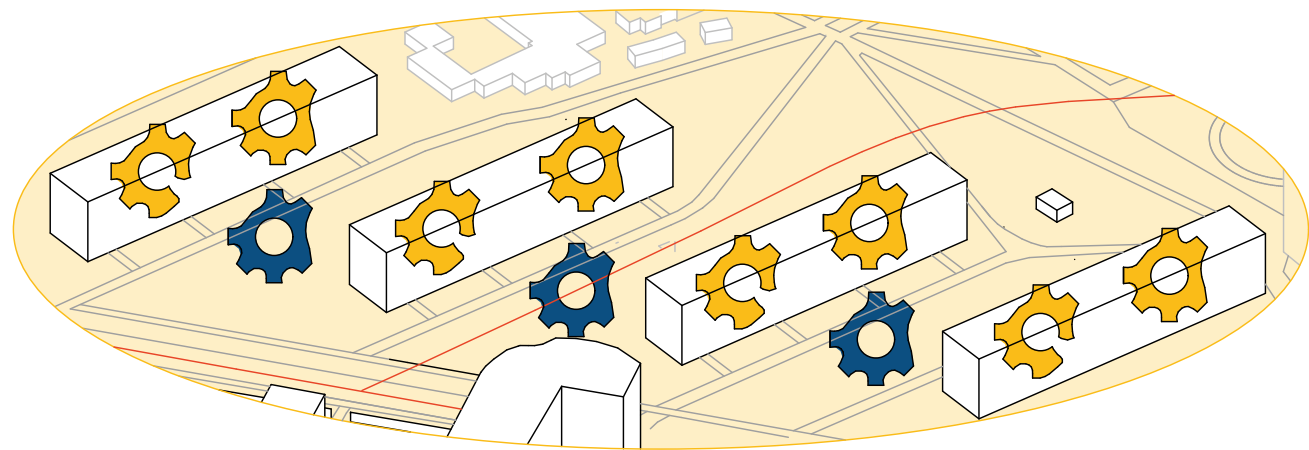

proposal

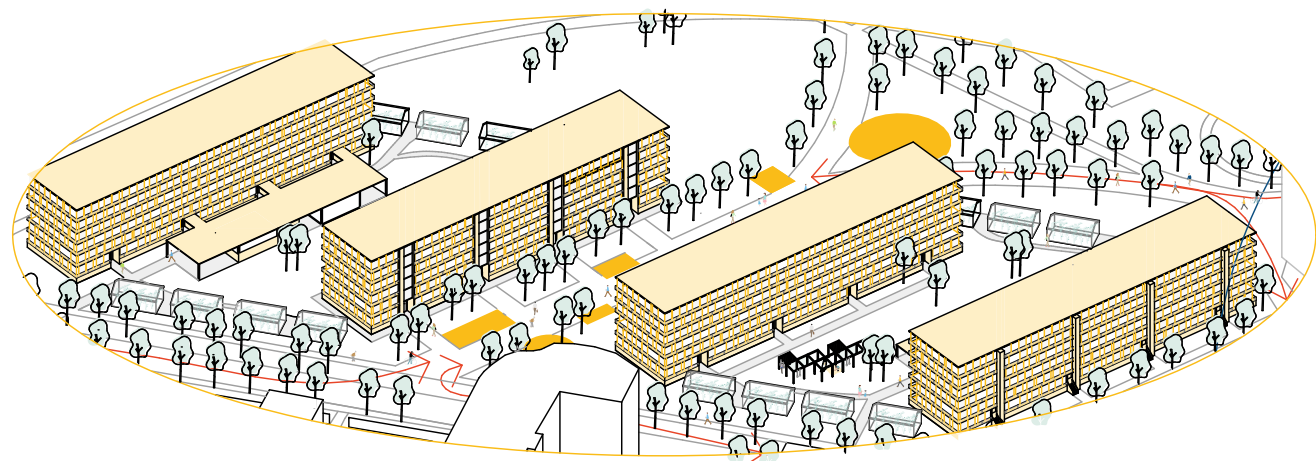

undefined space

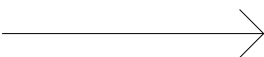

redefining



creating public and semi-public spaces: accentuate by adding functions



minimal living space



redefining



improve private space



no accessebility

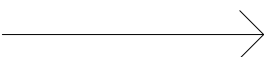

reinterpretation

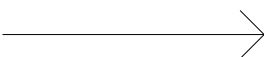

provide accessebility



visual seperation: green houses



different functions



community rooms



density



mobility



route guidance: tree-lined avenue



zones



public space

2nd Intervention area

process intervention: defining free space

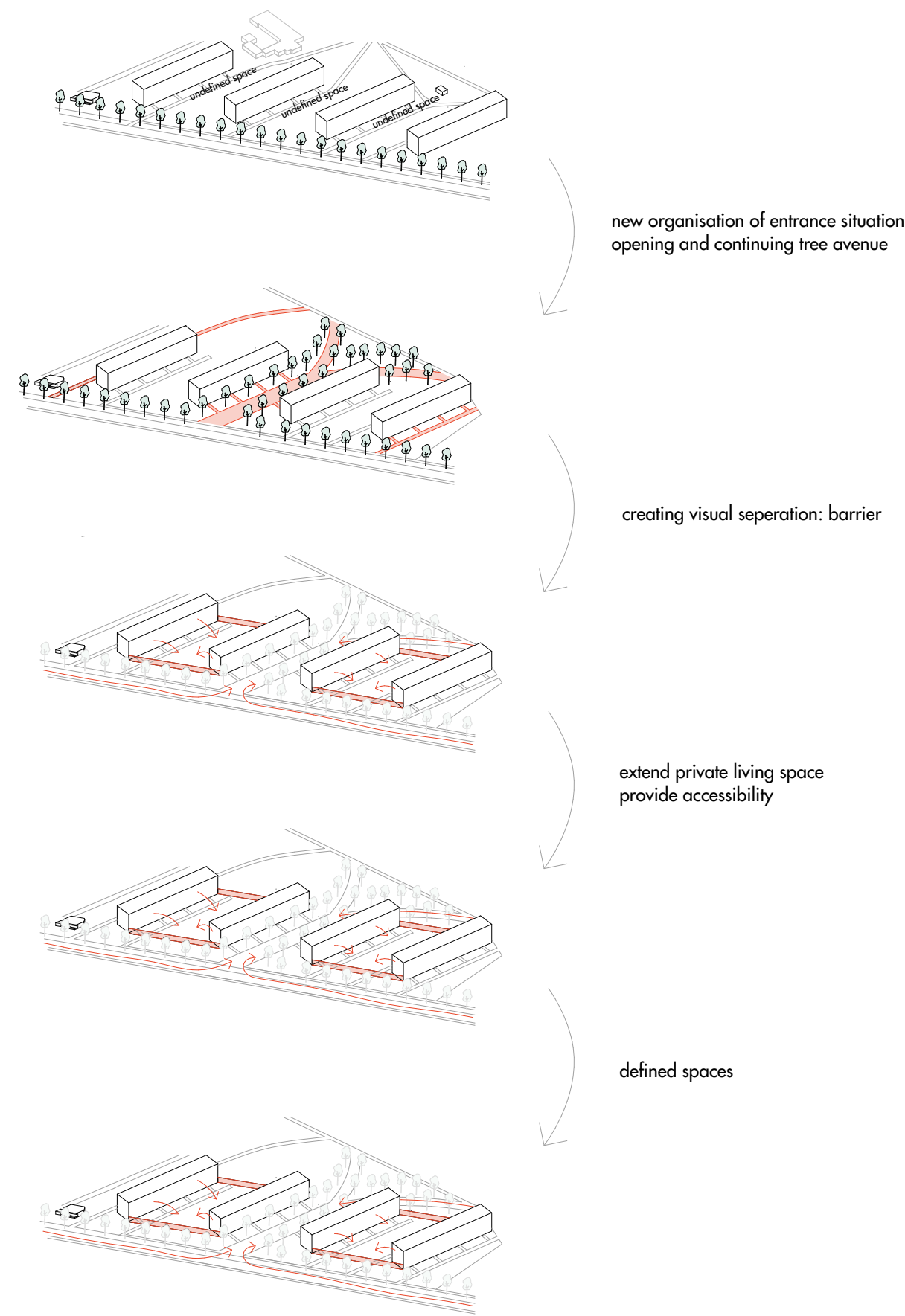

process apartment building

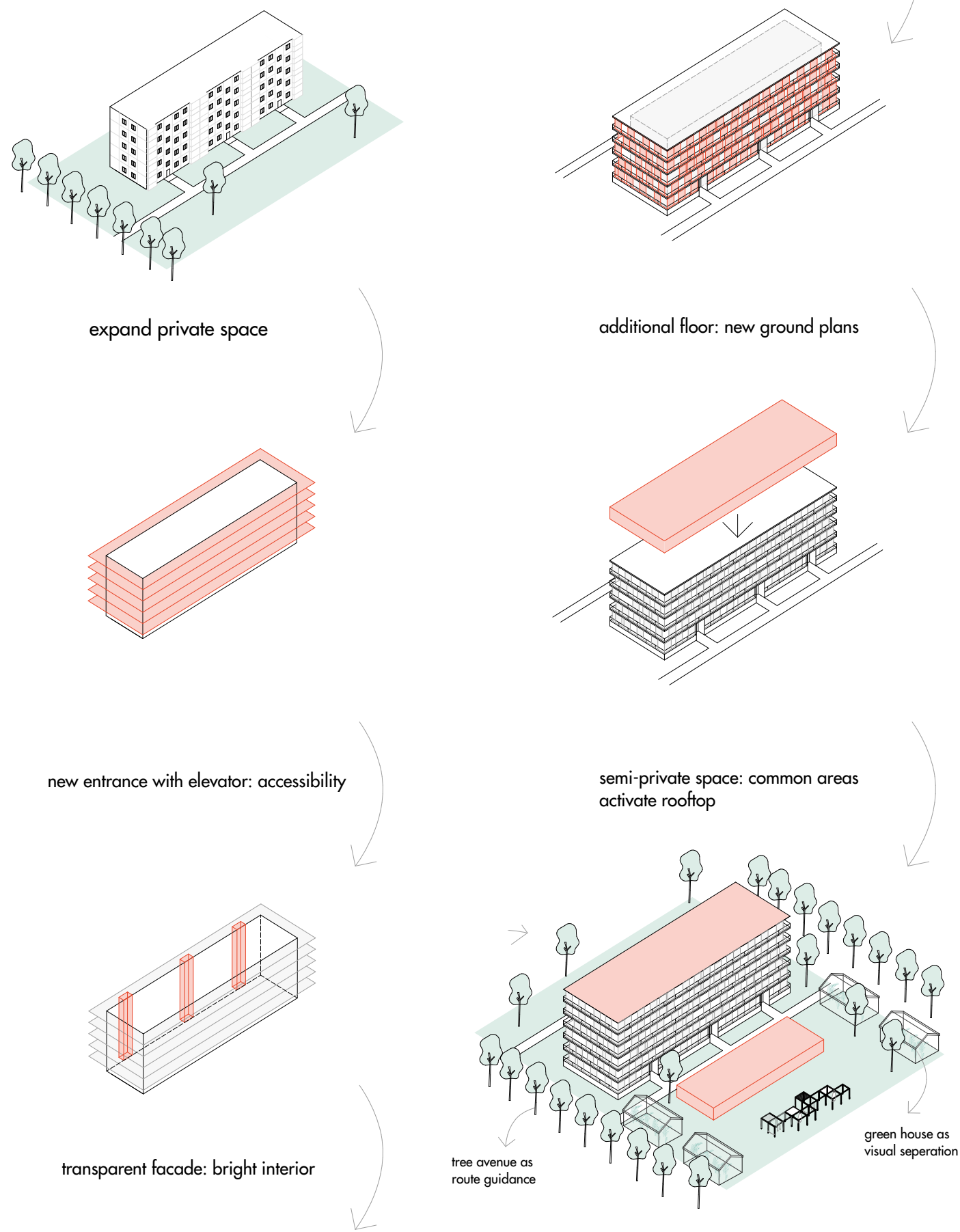

ground floor | 2nd intervention area

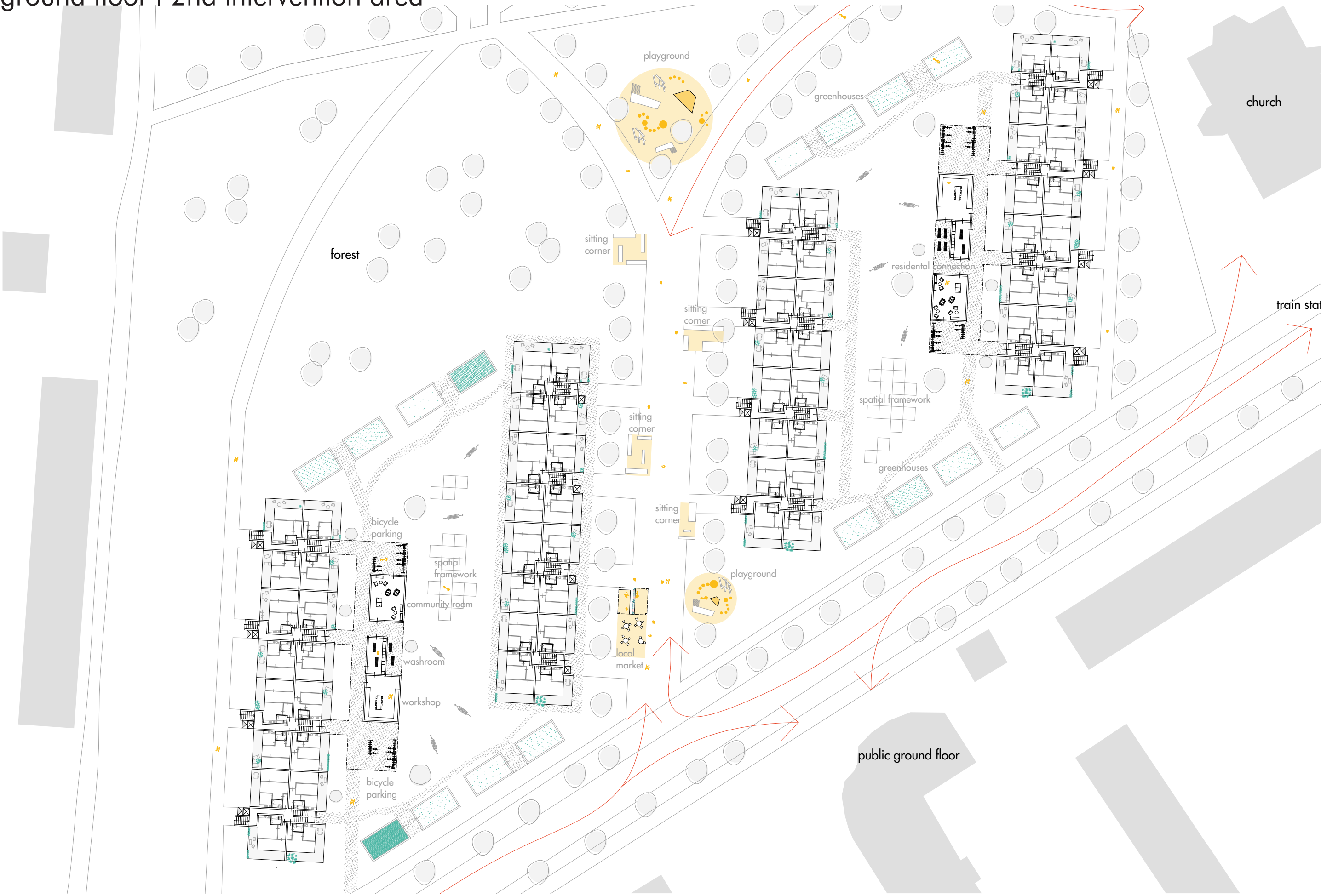

route guidance



public functions (playground, sitting corners, market)

2nd Intervention area

semi- public space: green space

spatial framework

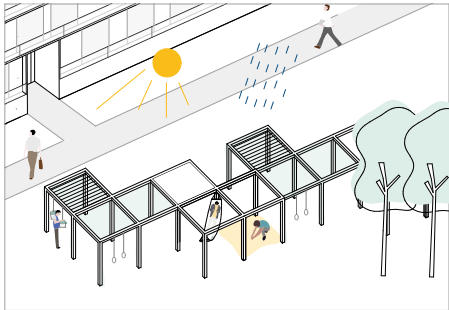

different uses for all ages

greenhouses

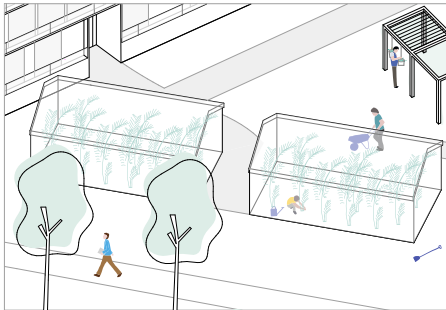

intensive gardening

resident connection

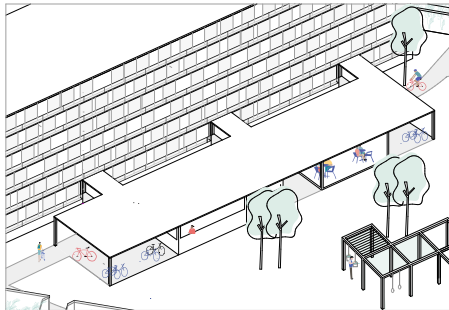

bicycle parking, workshop, washroom, community room

semi-public space: rooftop

chill-out walkabout

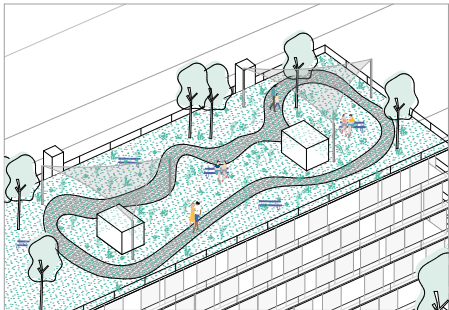

relaxing on the green rooftop

green oasis

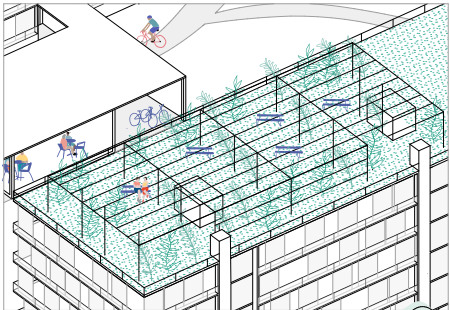

shady sitting on the green rooftop

public space:

wide path

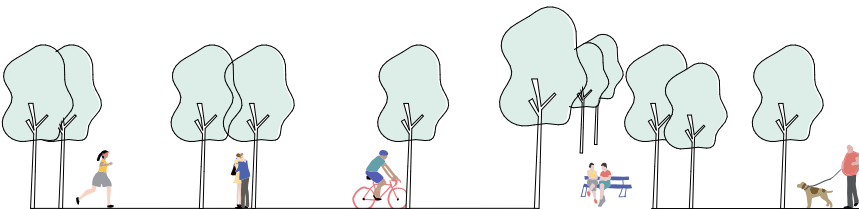

wide path on the entrance side of the apartments:
connection to the train station, cycling, running, strolling,
encounter, linger, relaxing

playground

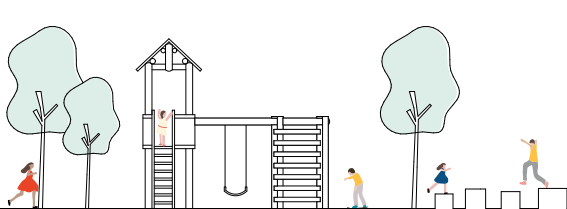

different activities for children

sitting corners

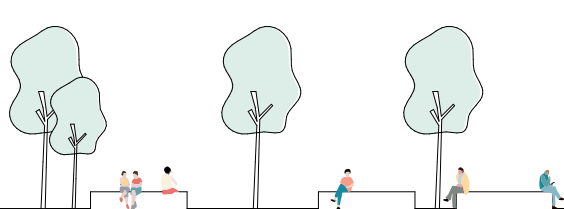

exchange, encounter, relax

sitting corners

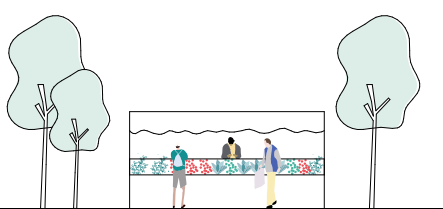

ground floor proposal

private space:

new organisation of entrance situation
regular floor existing | ground floor existing

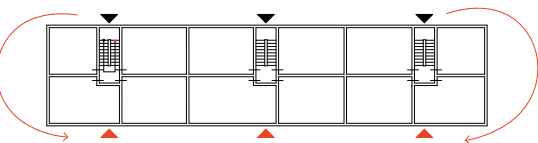

transformation

expand private space; accessibility
regular floor proposal

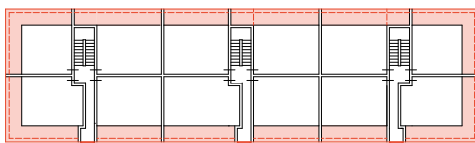

ground floor proposal

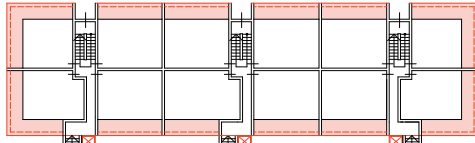

additional floor proposal

