

"COUNTRY HILLS"

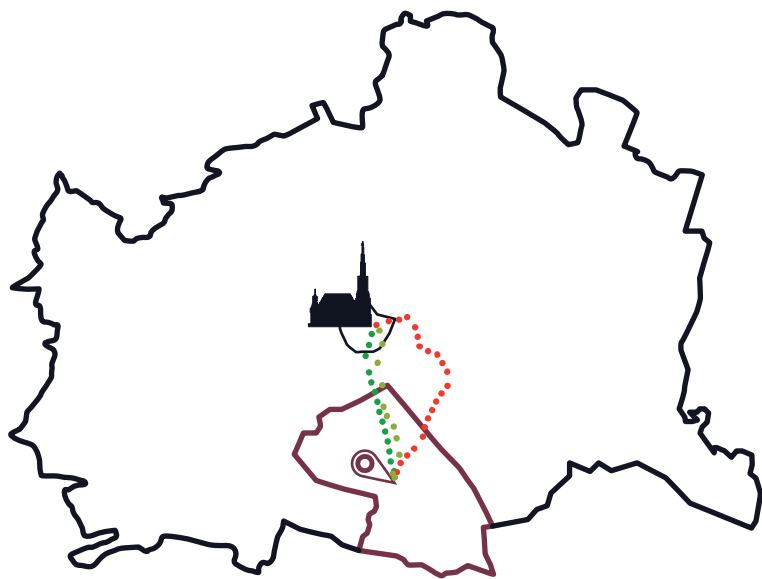

A farm in the middle of the Verteilerkreis? Quite Surprising, isn't it?

Given the fact that Vienna is a megacity, it is highly agrarian. 17% of the area is used for agriculture. Daily 180 tons of vegetables are produced, which is a 35% self-supply-rate for Vienna. This fact inspired us to contribute to this Viennese characteristic and build a farming city on our site. It is thus a city quarter with a focus on farming, agriculture and self-supply. Combining Housing, Farming, Food production, a Residence for seniors, Education and Culture, we want to create a place with as much urban life aspects as possible. The ground level will be used for shops, offices or studios. This way, a high degree of public life will be guaranteed.



$$S = 3.426 \text{ ha}$$

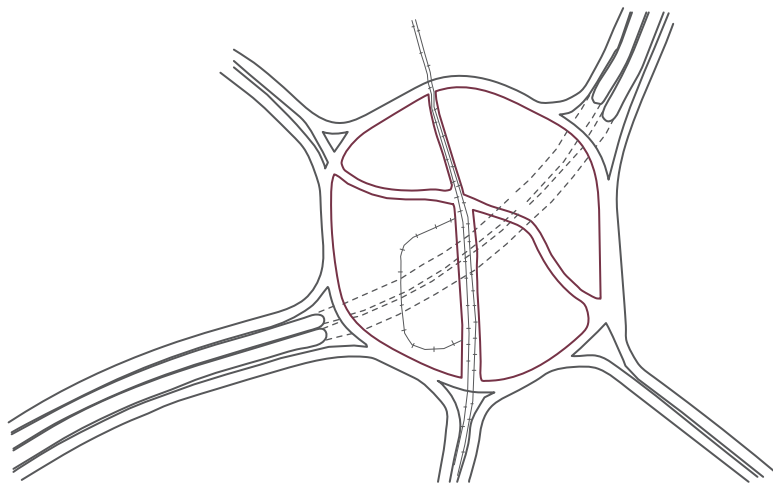

SKETCHING

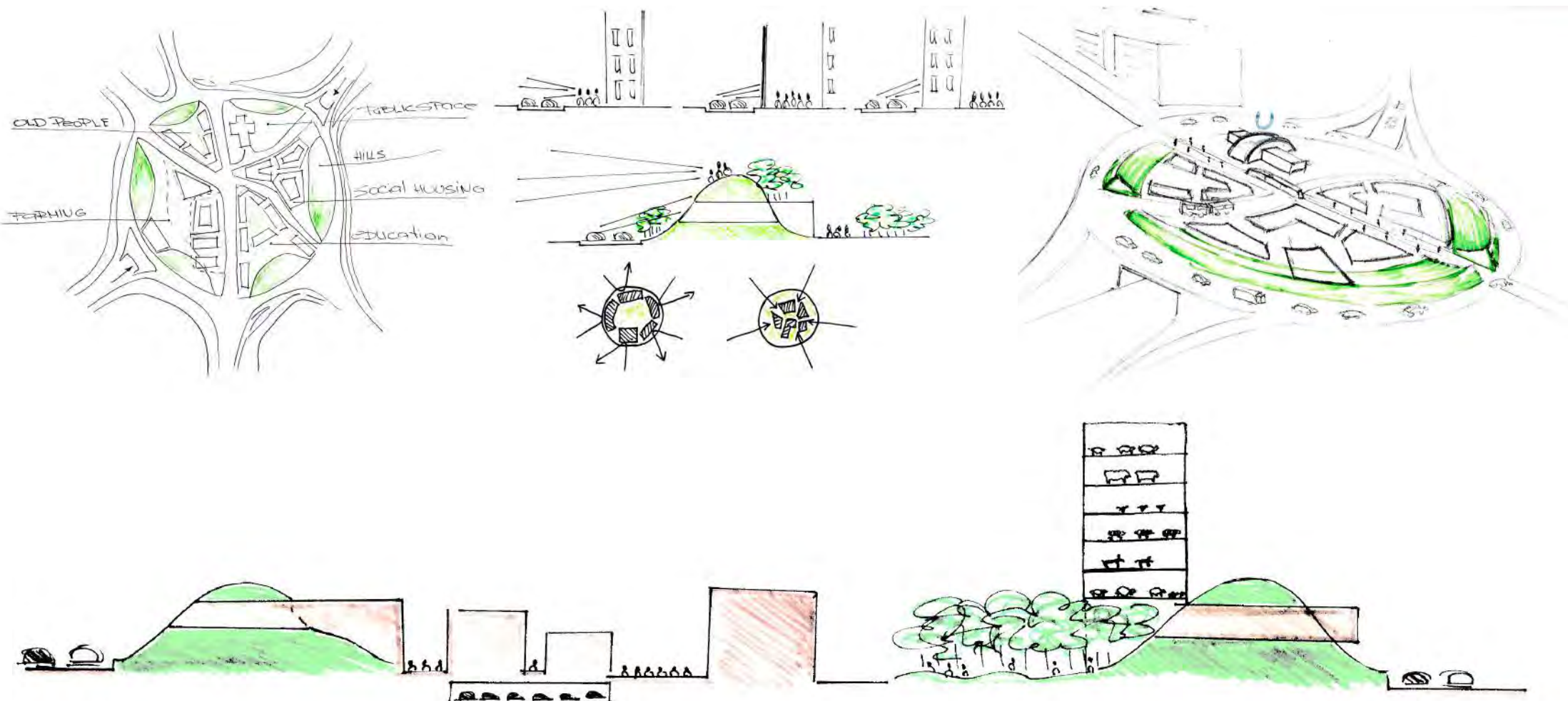

Valeria Palahuta
Taras Pakholiuk

L'vivska Polytechnika
faculty of architecture, UKRAINE

Giorgia Pierleoni, 1429595
Kamila Dršata, 1025034

Vienna University of Technology
faculty of architecture and regional planning,
AUSTRIA

260.374 New Urban Density. Vienna summer 2015
Andreas Hofer [vie], Anton Kolomyeytsev [liv], Elisabeth Leitner [vie], Andreas Lint [vie], Halyna Petryshyn [liv]





PRESENT SITUATION

FUNCTIONAL
ZONING



TRANSPORT
AND MOBILITY

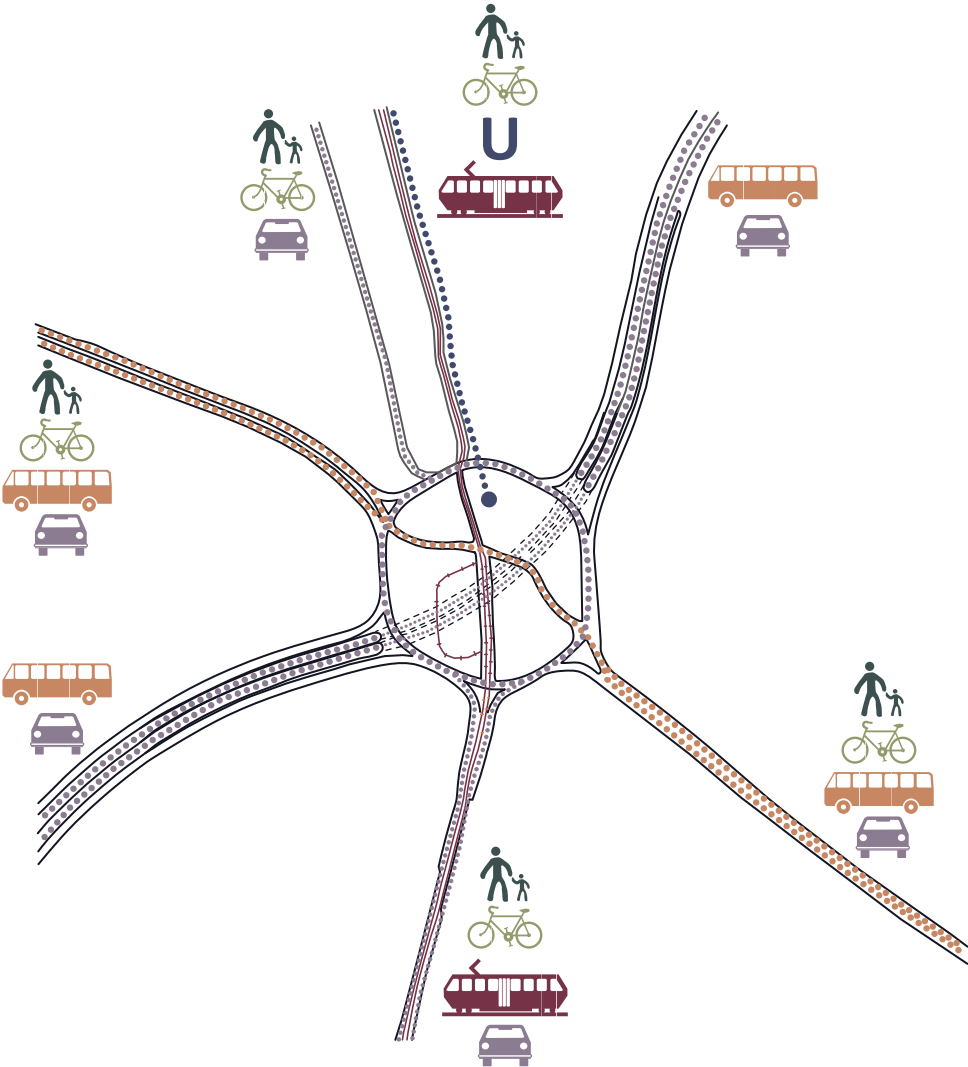

BUILDINGS
HEIGHTS

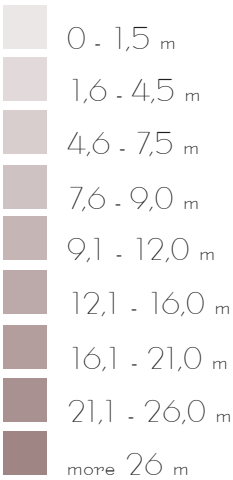

GREENING

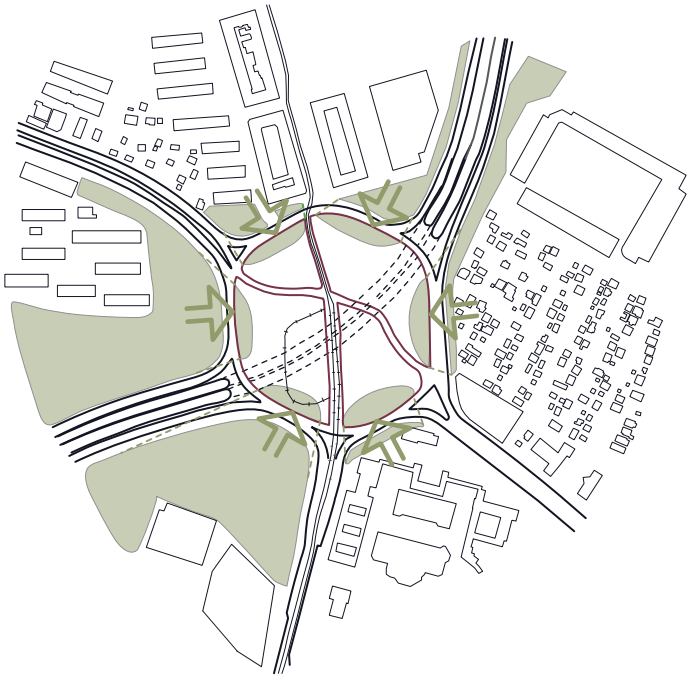



PROJECT IDEA

U

STRENGTHS



NEARNESS TO THE CITY CENTER

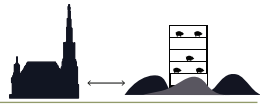

VARIETY OF SURROUNDINGS



TRAFFIC JUNCTION



NO INNER LIMITATIONS



VIEW OF VIENNA'S COUNTRYSIDE



OPPORTUNITIES



URBAN STATION



VARIETY OF SURROUNDING FUNCTIONS



TRAFFIC CIRCULATION



NO INNER LIMITATIONS



GREEN PRESENCE

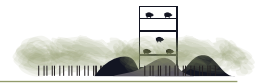

VIEWS OF VIENNA'S COUNTRYSIDE



WEAKNESS



TRAFFIC



NOISE



POLLUTION



CARS PREDOMINANCE



NOT NICE SURROUNDINGS



THREATS



TRAFFIC CIRCULATION



PERIPHERY AREA

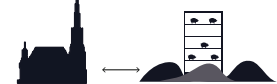

LACK OF PEOPLE IN THE SURROUNDINGS

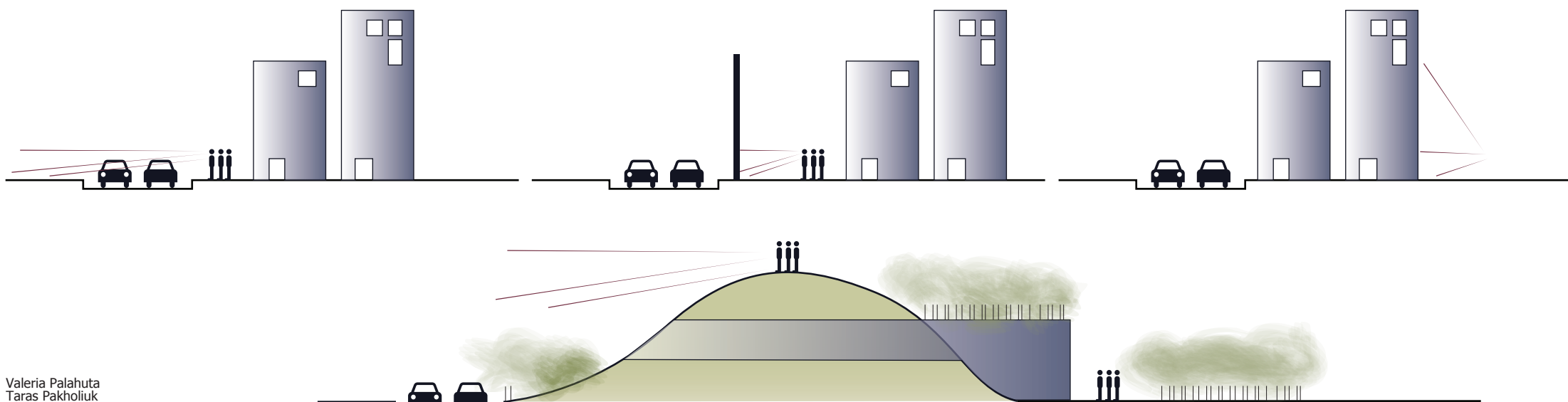
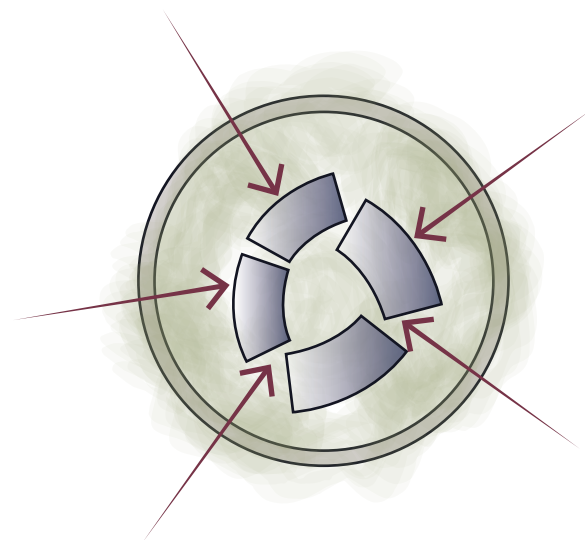
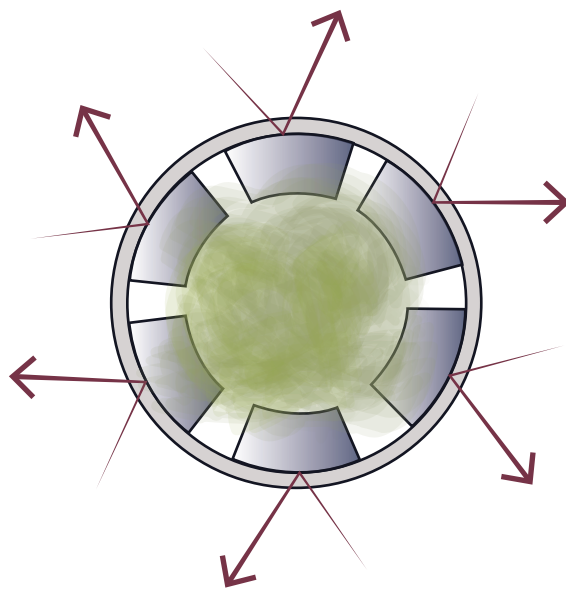



PROPOSITION

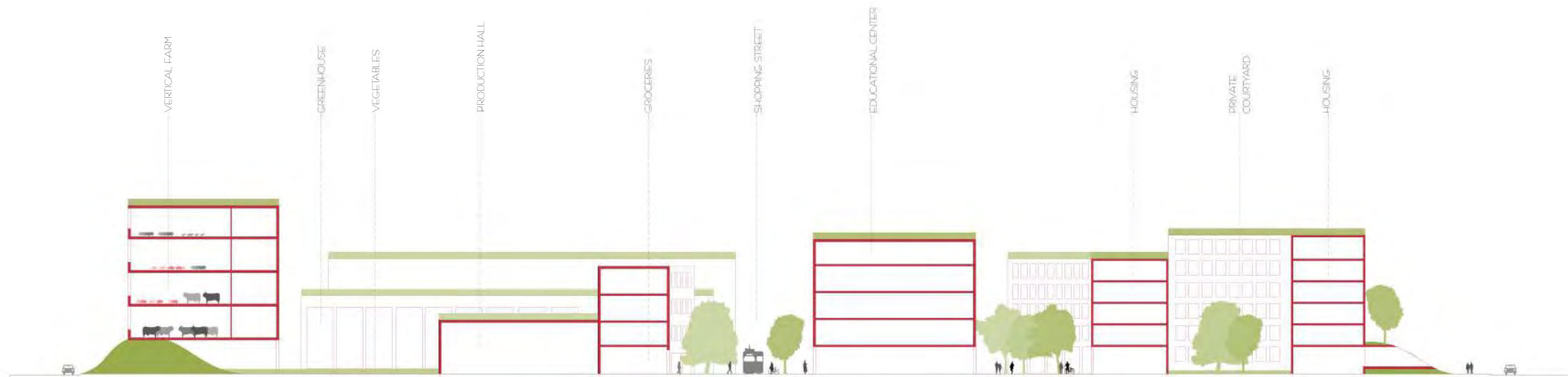

CONCLUSIONS

GOALS



SELF-SUPPLY DEVELOPMENT



A DIFFERENT VISION OF LIFE AND WORKING



GIVE PERSONALITY TO THIS STRATEGIC PLACE

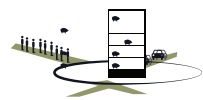

VISIONS



SMART AND SUSTAINABLE DEVELOPMENT



GREEN AS A PREDOMINANT ELEMENT



CONNECTION WITH THE CITY CENTER BUT STILL INDEPENDENT



NEXT STEPS



U BAN CONSTRUCTION



PROMOTION OF A NEW WAY OF LIVING



BUILD STRATEGIC BUILDINGS THAT ATTRACT PEOPLE FIRST





FORMING OF DISTRICT STRUCTURE



1. SAVING OF EXISTING TRANSPORT AXIS

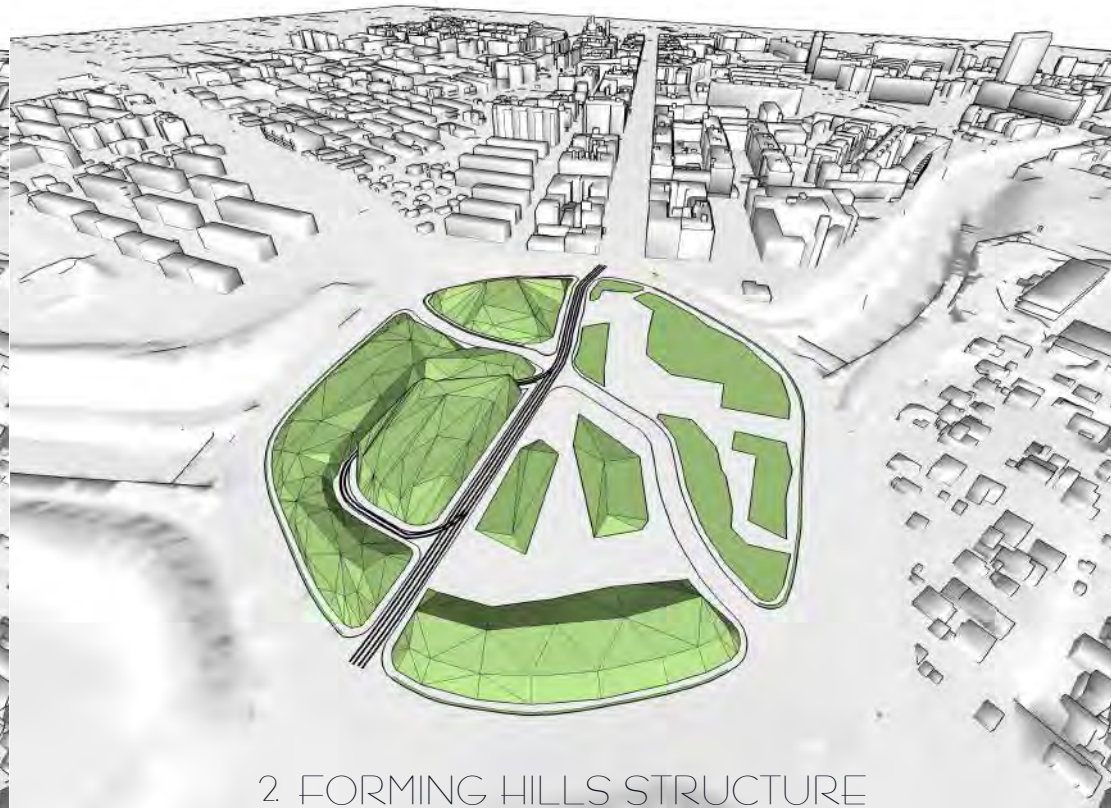

2. FORMING HILLS STRUCTURE

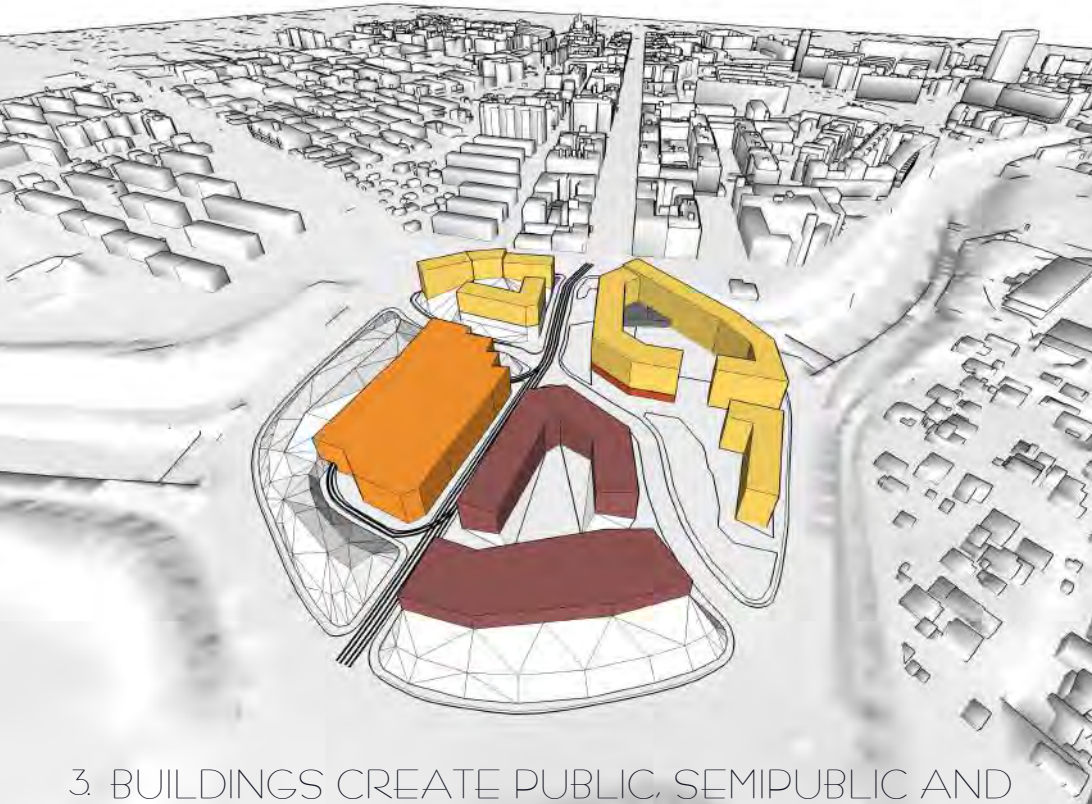

3. BUILDINGS CREATE PUBLIC, SEMIPUBLIC AND PRIVATE SPACES

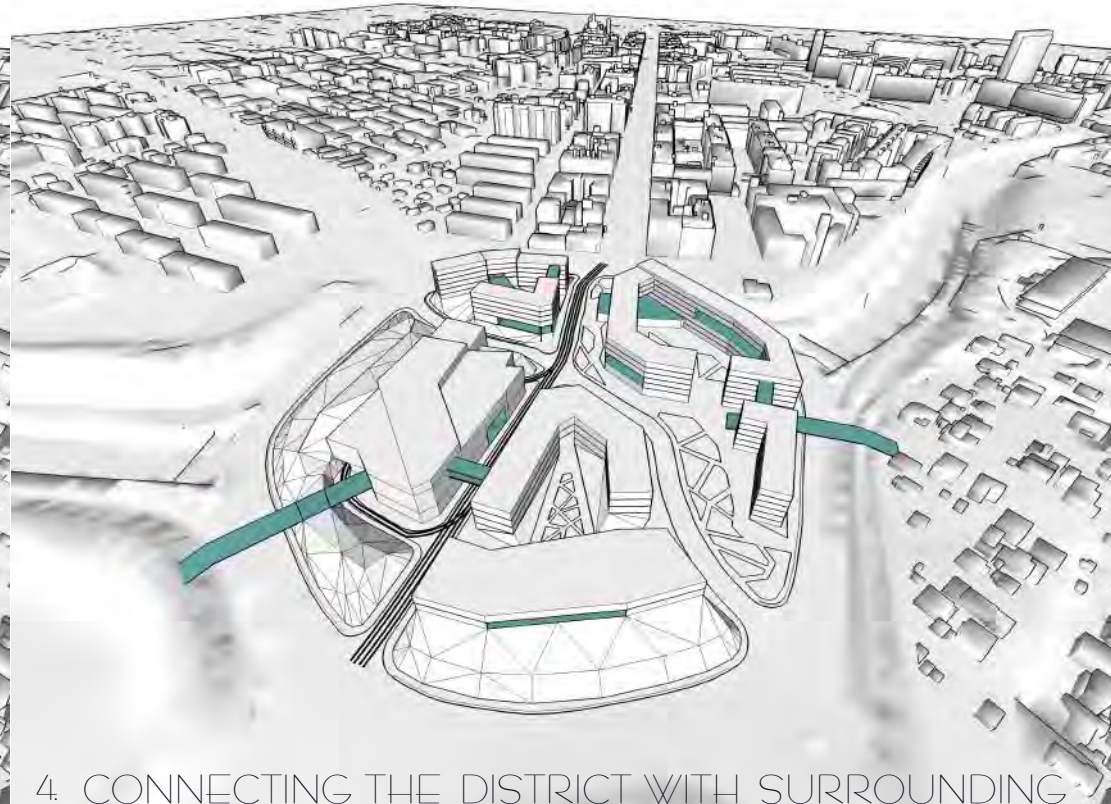

4. CONNECTING THE DISTRICT WITH SURROUNDING TERRITORIES BY BRIDGES AND VISUAL DIRECTIONS



5. PLANTING THE TREES SIMILAR TO THEIR NATURAL PROCESS OF GROWING





Vienna / Verteilerkreis "VIENNA LUNGS"



MAIN TASKS OF THE PROJECT

BREAKING BORDERS OF TRAFFIC RING

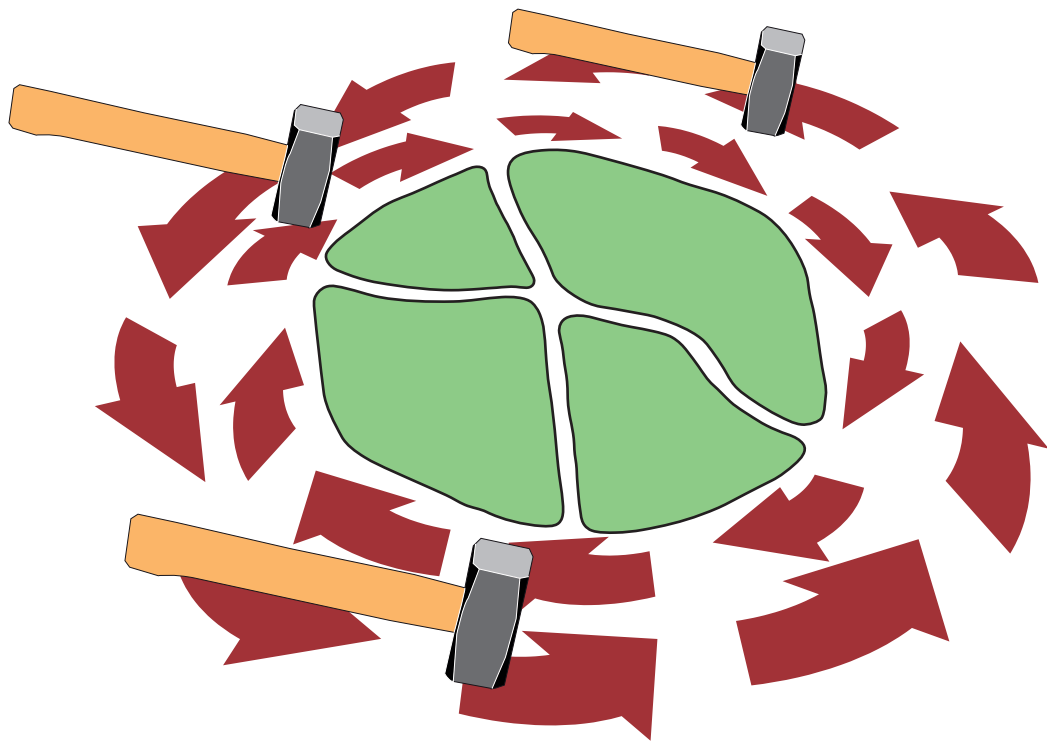

INVITING PEOPLE INSIDE THE DISTRICT

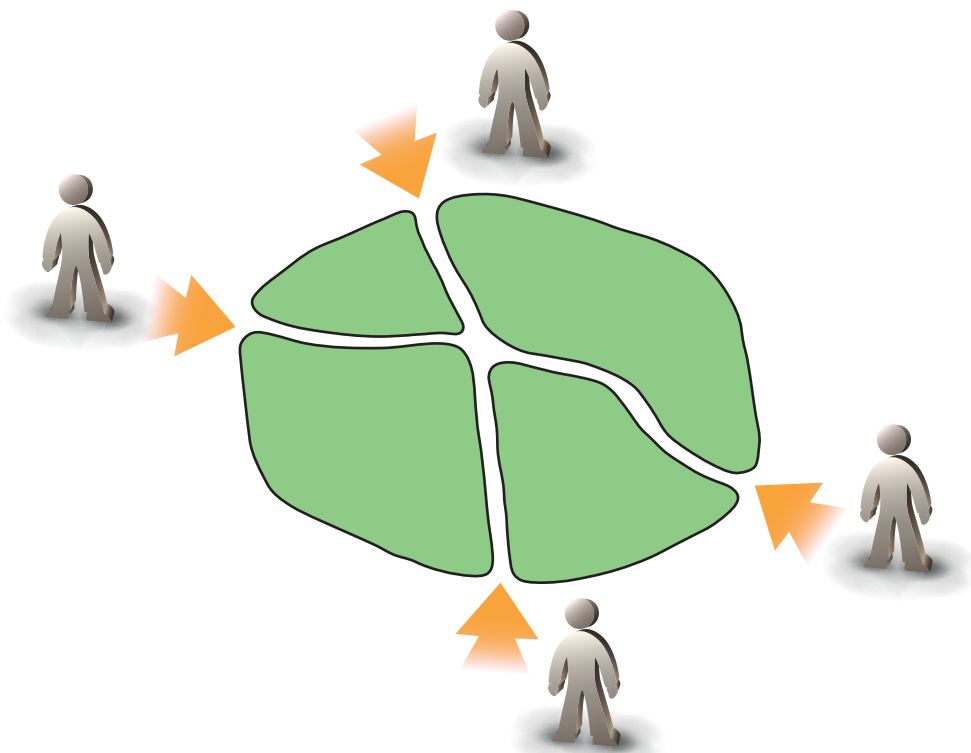

CREATING VIEW POINTS FROM THE DISTRICT CENTER TO THE OUTSIDE

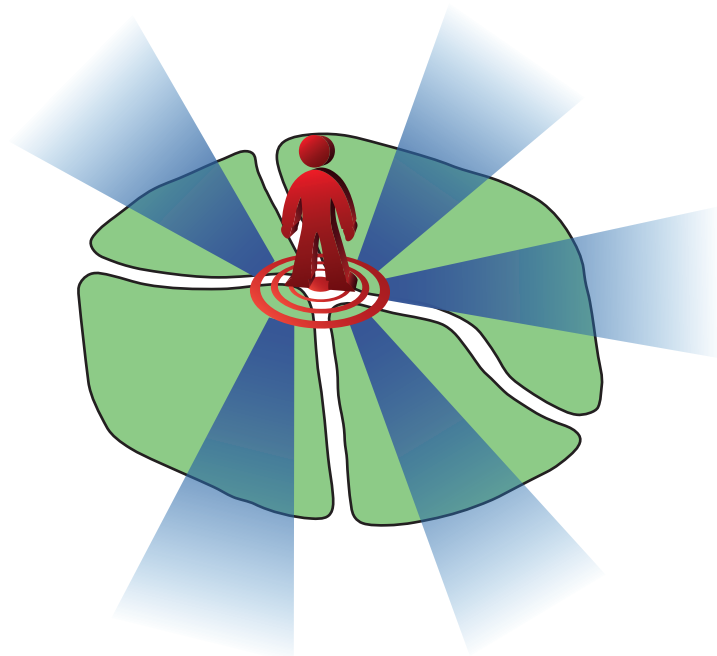

VISUAL CONNECTIONS

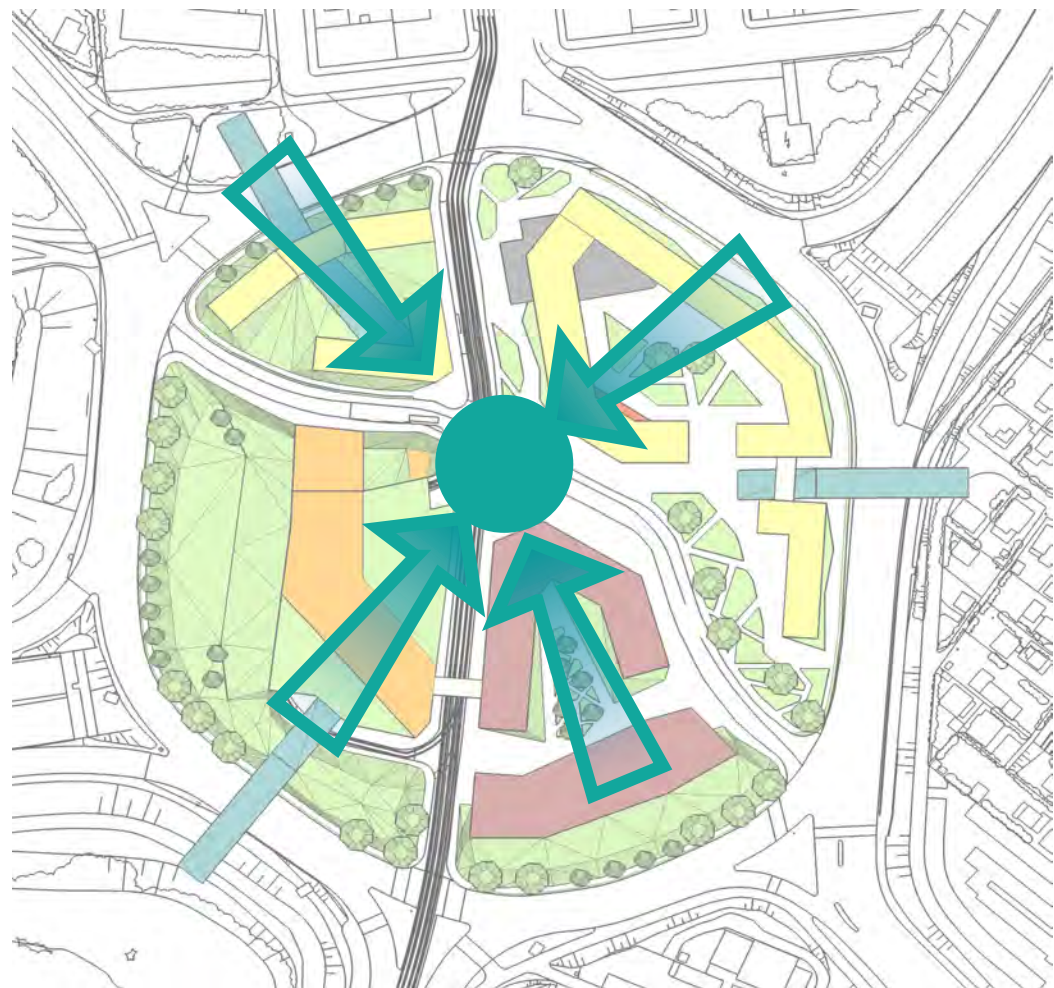

TRANSPORT

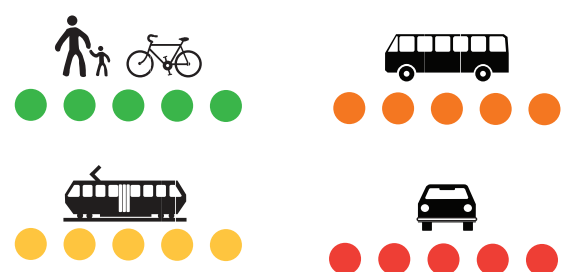
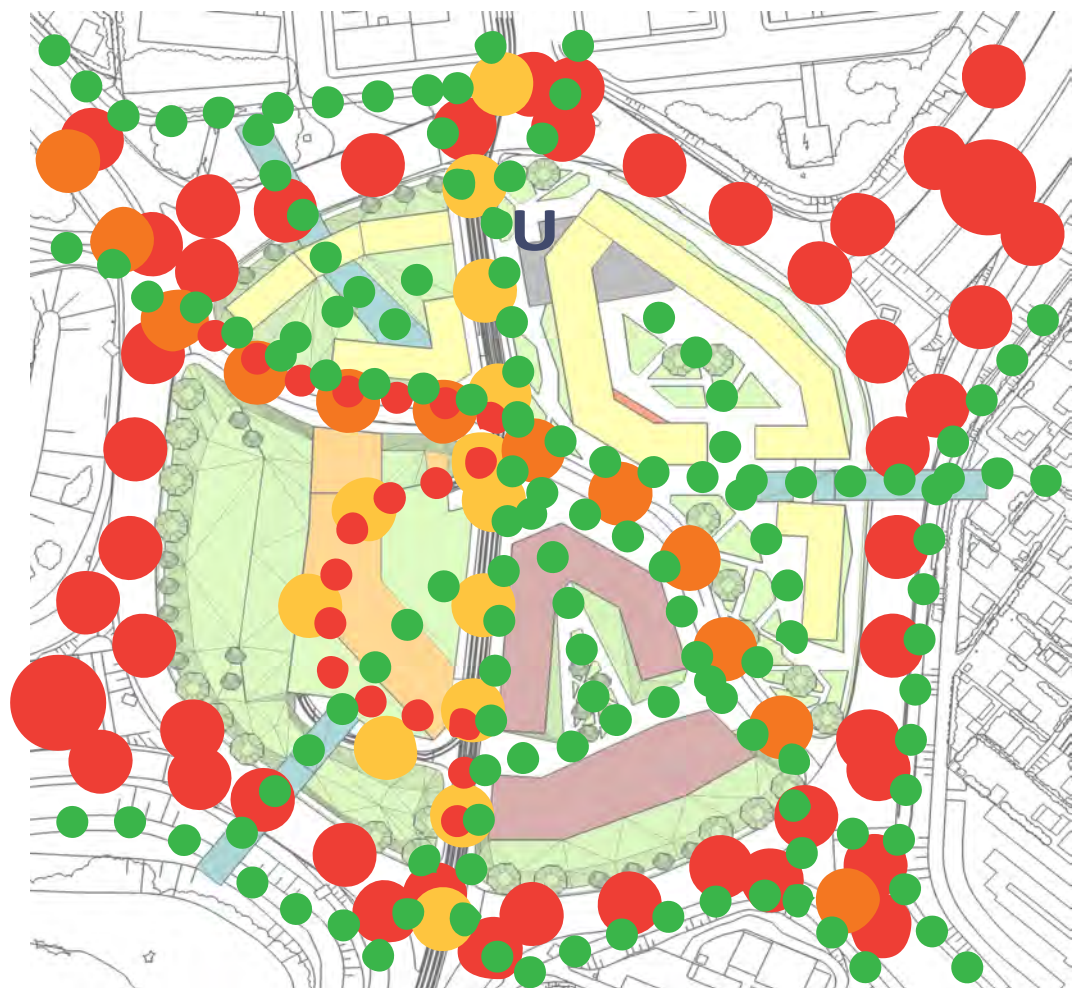



Vienna / Verteilerkreis

“VIENNA LUNGS”



MASTERPLAN



- 1. SHOPPING - EDUCATIONAL CENTER
- 2. HOUSING
- 3. EDUCATIONAL CAMPUS
- 4. UNDERGROUND STATION

- 5. PARKING
- 6. TERRACE
- 7. FLAT PARK
- 8. CONNECTION BRIDGE





Vienna / Verteilerkreis
“VIENNA LUNGS”



FLOOR PLAN

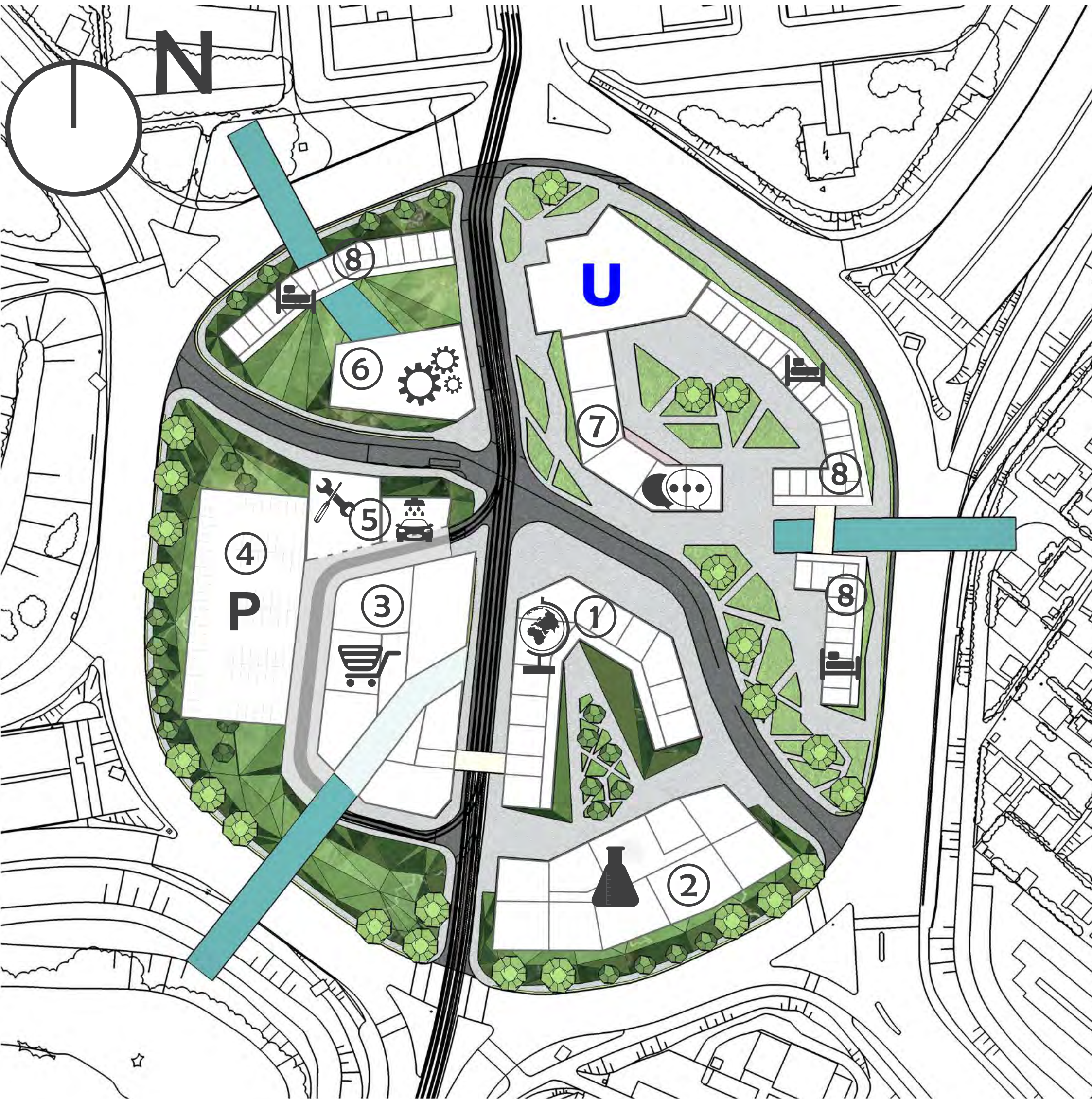

- 1. EDUCATIONAL CAMPUS
- 2. RESEARCH CENTER
- 3. SHOPPING CENTER
- 4. PARKING

- 5. CAR SERVICE
- 6. CO-WORKING SPACE
- 7. PUBLIC SPACE
- 8. HOUSING





Vienna / Verteilerkreis
“VIENNA LUNGS”

