

stay & go

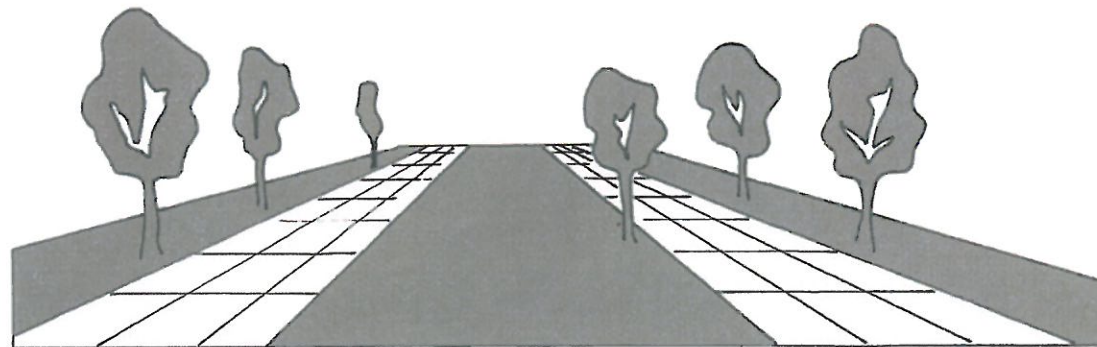

Cornelia Fankhauser 0752064
Janette Sesselmann 1026184

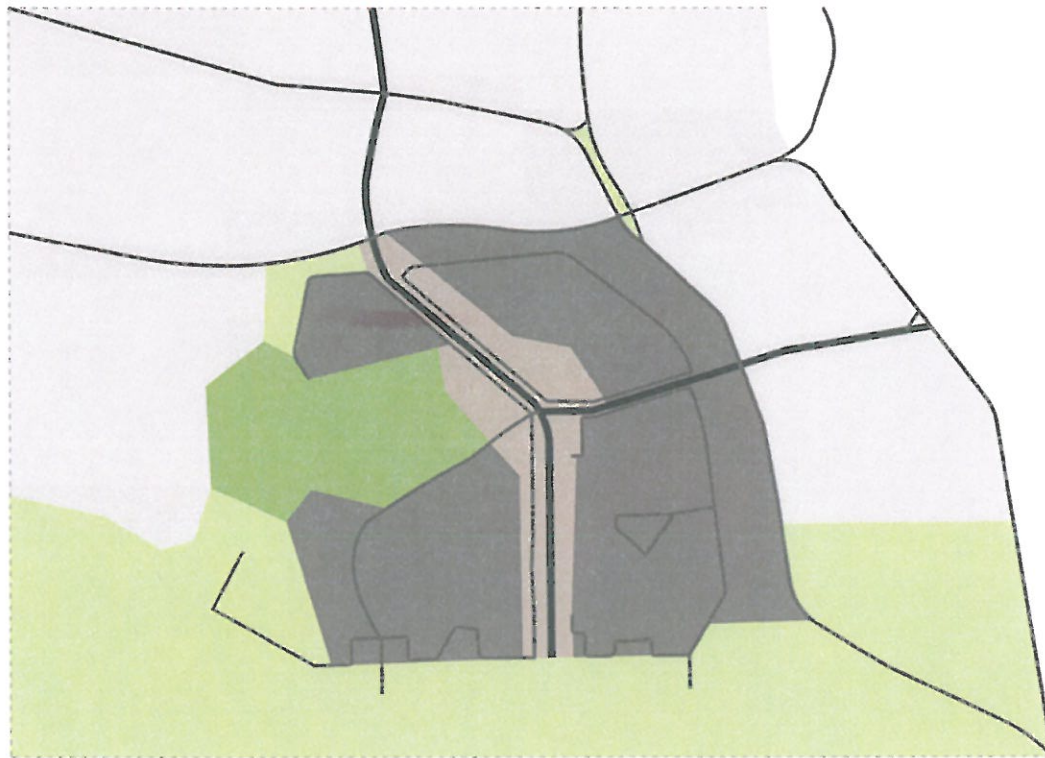

Today's Situation

After 1991 Sykhiv couldn't completely fulfill its original idea. The today's situation deals with several challenges: The public space is located only next to the main roads. The remained region is left with mainly living space divided in 12 districts.

Planning Idea 1960s

Sykhiv has a good connection to the inner city of Lviv because of several main roads. It is surrounded by an industrial belt and a green area nearby. The original idea implied a balanced relation between living area and public space.



Sykhiv

Sykhiv is structured in 12 micro districts. Each district contains public services like a kindergarden and a school. Around 120000 dwellers live there in total. The original plan also provided an inner circular connection for pedestrians which couldn't be built in its primary propose.

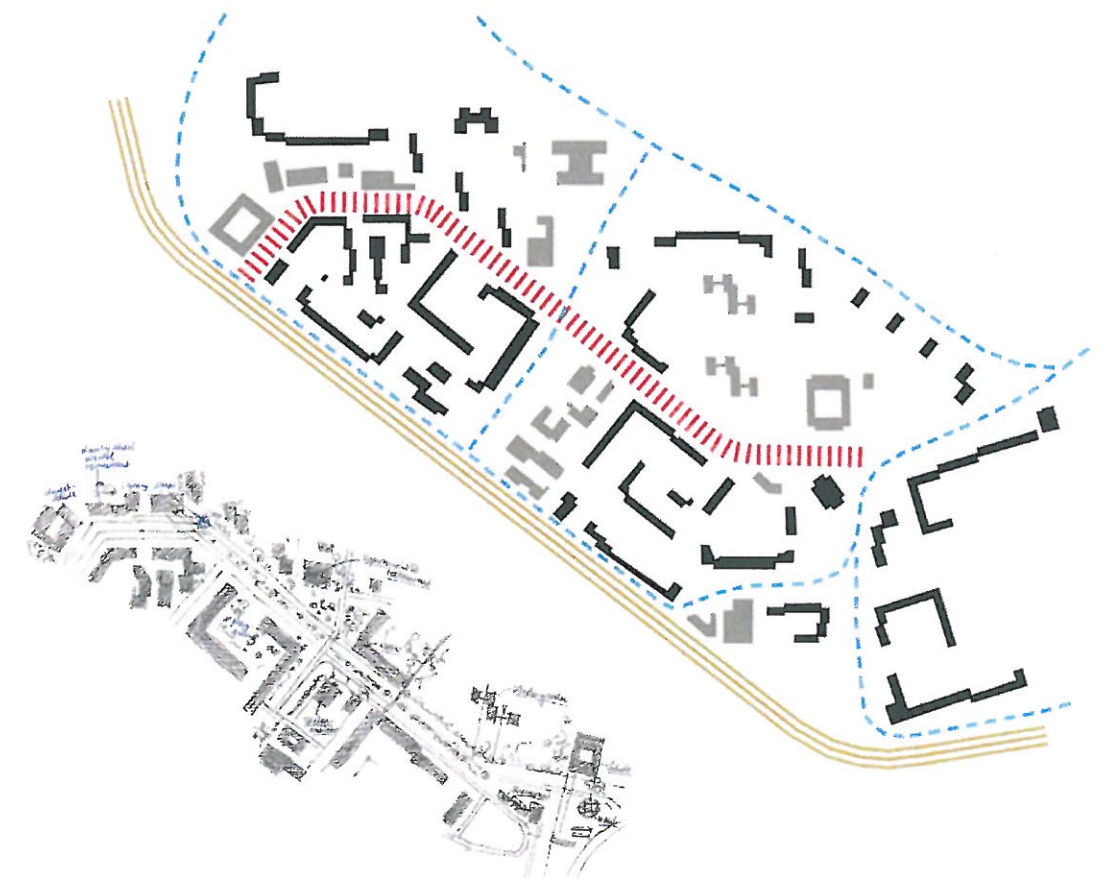

The Boulevard

Nevertheless, if you look closer you can find some remains of the original idea and even a very good preserved so called boulevard which is located in the north part of Sykhiv and was actually planned to be the cultural center of the whole area.

boulevard - analysis

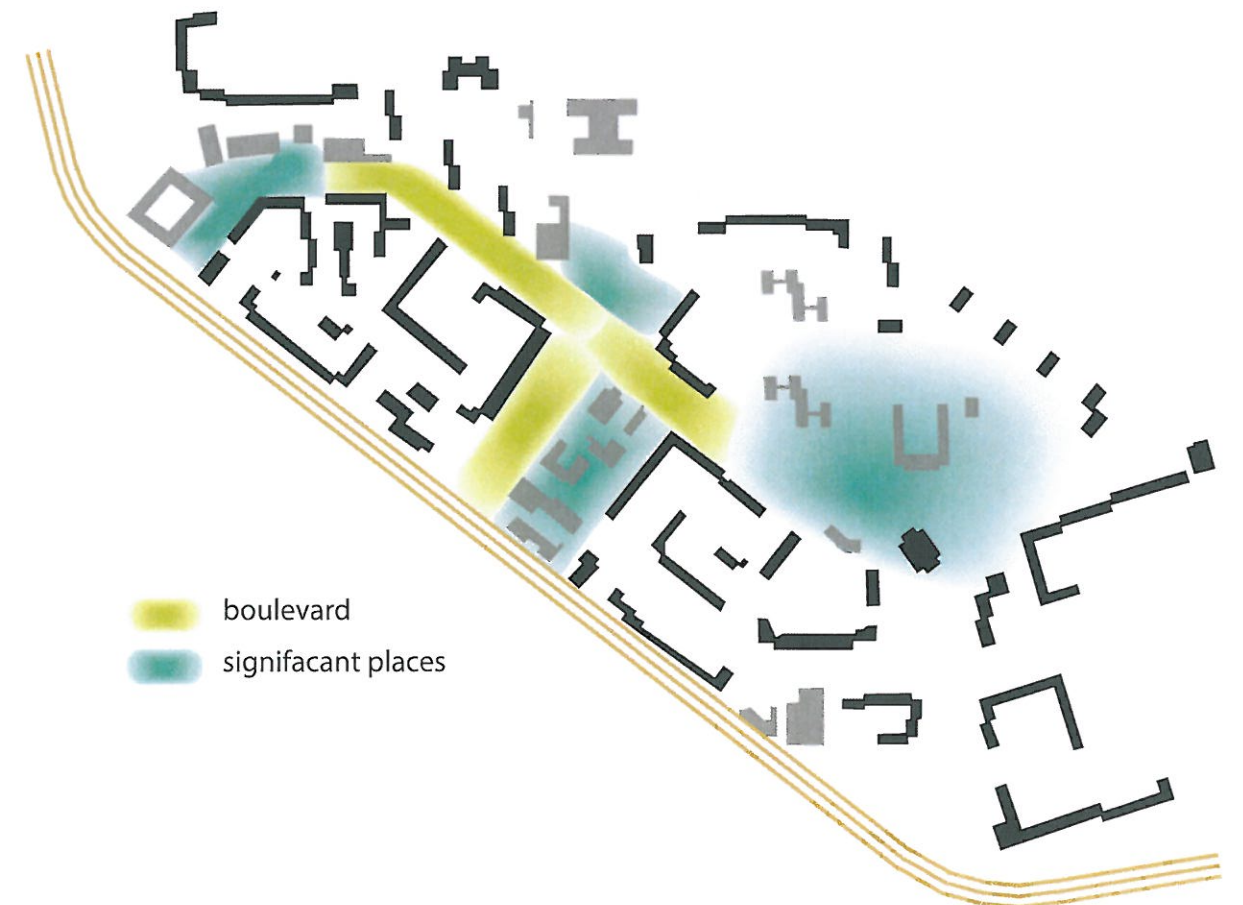
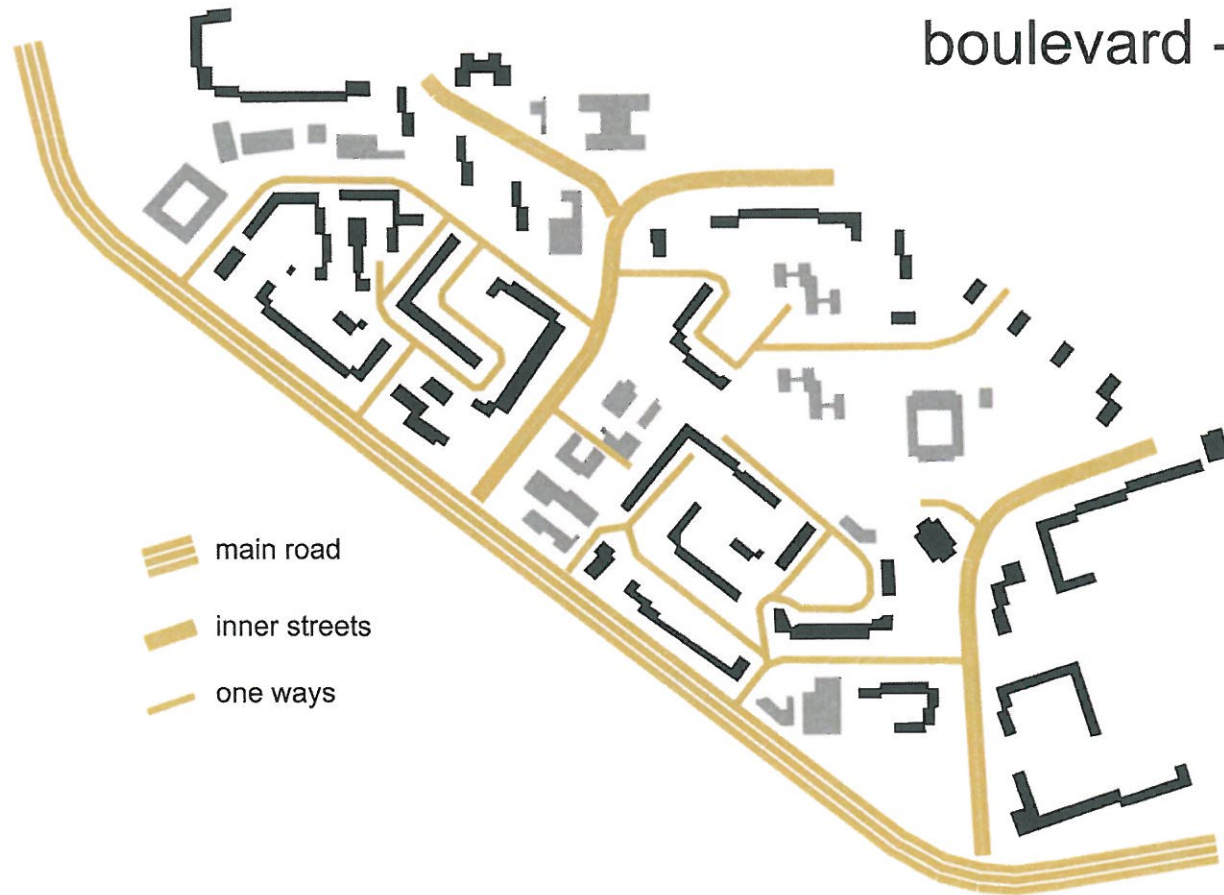

pros & cons

art area



- visible connection with the main road
- areaway in front of the art school
- sidewalk café next to the art school
- large green area as part of the art school premises



- public space used for parking
- art school doesn't attract attention
- art school's green area isn't used by the students
- sidewalk café is giving a shabby impression, hidden behind bushes

hang out, leisure



- a lot of infrastructure / shops
- in-line connection boulevard - main road



- wide public area isn't used by the people
- infrastructure buildings are isolated

neighbourhood / urban gardening



- central place at the boulevard
- restaurant



- space in front of the restaurant isn't used
- disused green area

kids / action area



- landmark tower



- area surrounding kindergarten and school is separated from the remaining district
- place of low standard / feeling lost
- wide public area without any function

boulevard



- connects the individual areas
- tree population & grass strips



- no visible final point
- flooring is in a bad condition

The Boulevard will be structured in several zones according to the needs of the surrounding area



new areas

neighbour-
hood

kids area



hang out area



leisure





Artschool Entrance

The Art Area will be improved by changing the floor into an artistic mirror of the facades of the surrounding area. The public space will be set with art installations built by students of the nearby art school.

In the Art Area the bare walls will be painted with drawings by students of the nearby art school.



Library area



Boulevard Situation

The linear connections between the areas will be improved by street furniture and a new flooring.



The Main Square connects both sides and will be designed as the new meeting point of the boulevard. It includes a new flooring design with street furniture and an open-air cinema for several events to happen.

Main Square

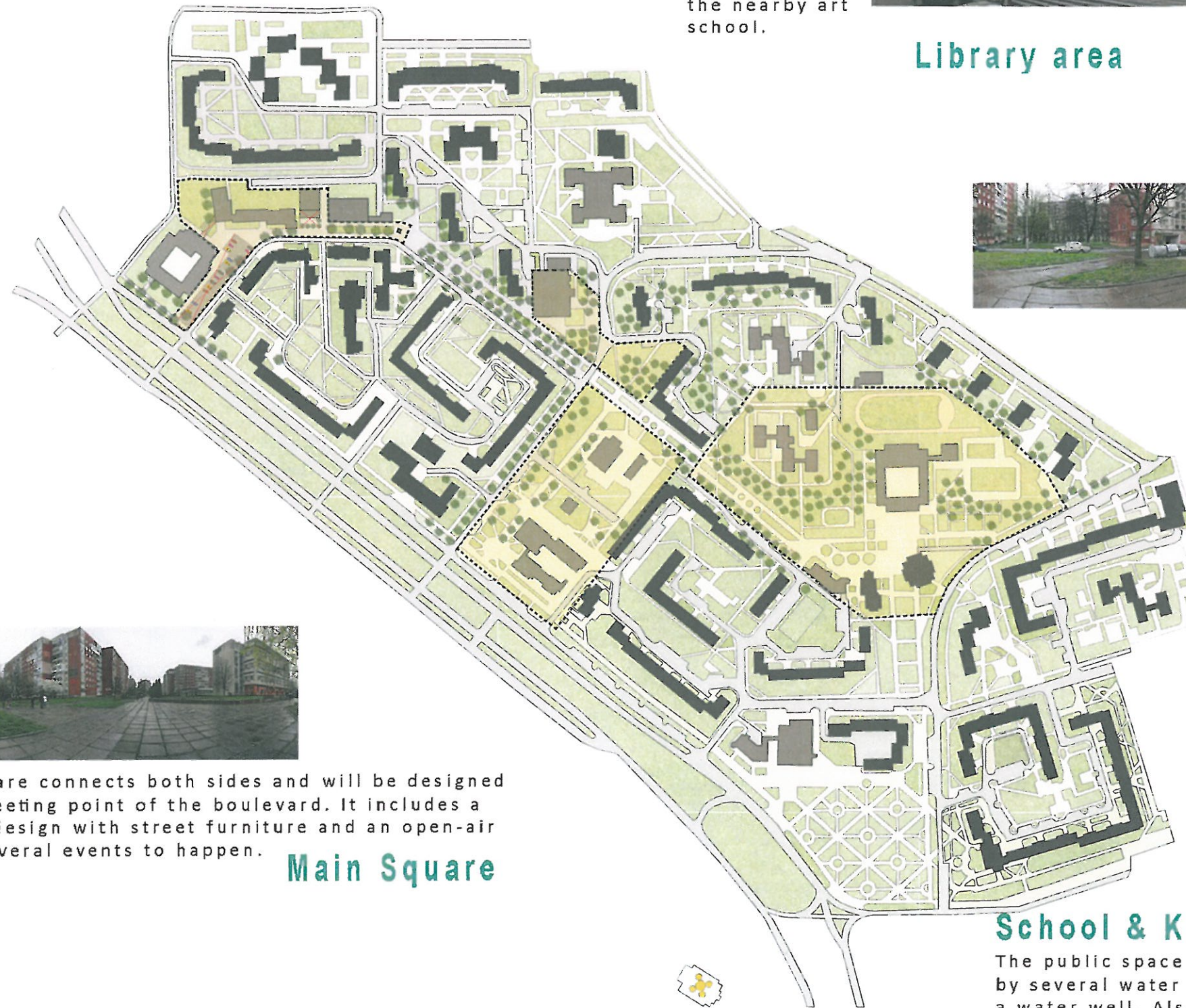

School & Kindergarden Entrance

The public space of the Kids Area will be improved by several water features like a trick fountain and a water well. Also, the area will include a lot of activity facilities (e.g. playgrounds for basketball, volleyball, boulder area, grill & chill zone).



2014

1 temporary interventions

art installations

urban gardening

temporary pool

temporary grill place

open air cinema

street furniture

2 redesign

colourful rubber floor

different kinds of gravel

outdoor wood floor

3 creation of identity



appropriation of the facade with the dweller's participation (cf. Ultra Architects, 'losowanie!')

What is happening?

20??

art area



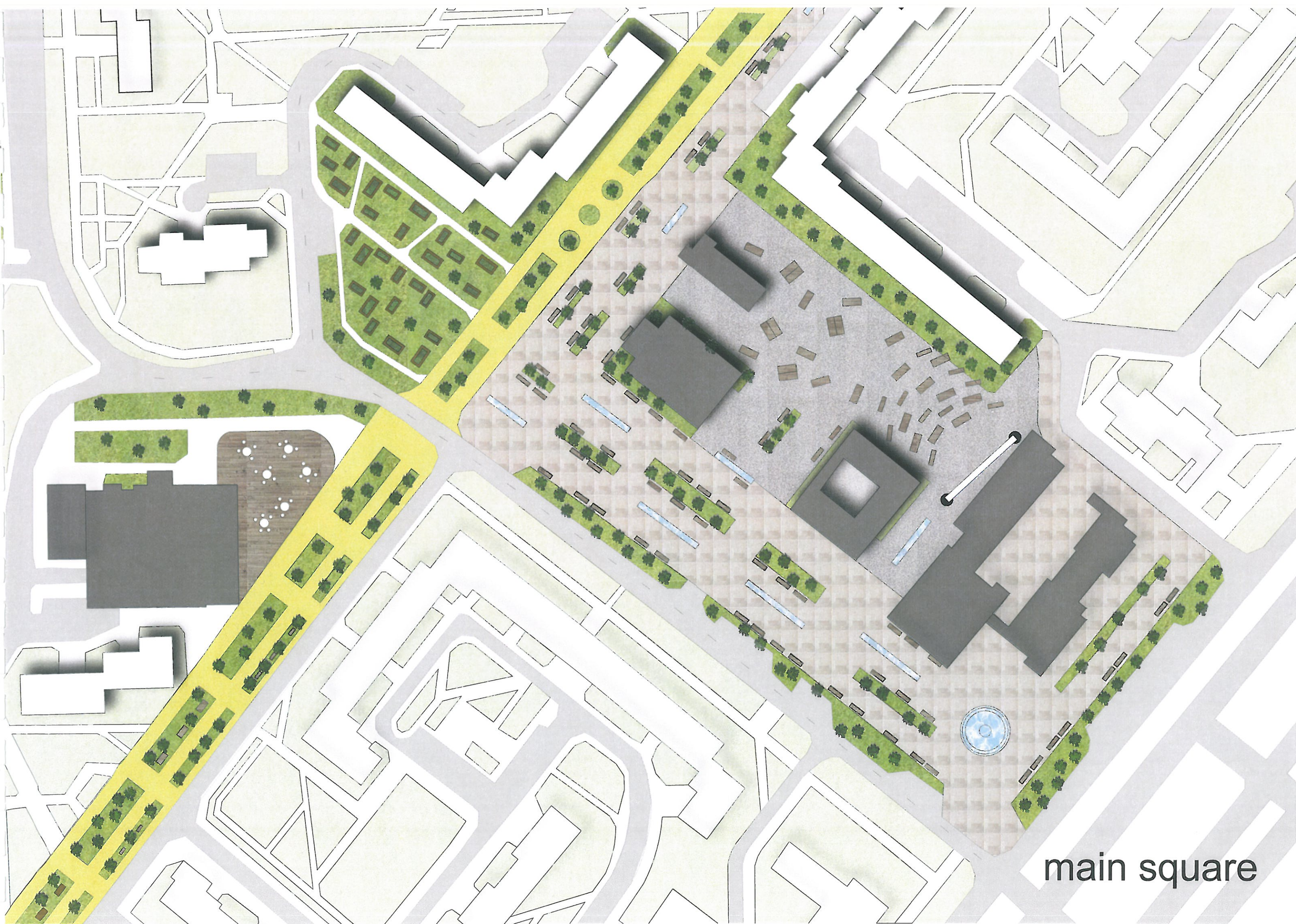

main square

kids area

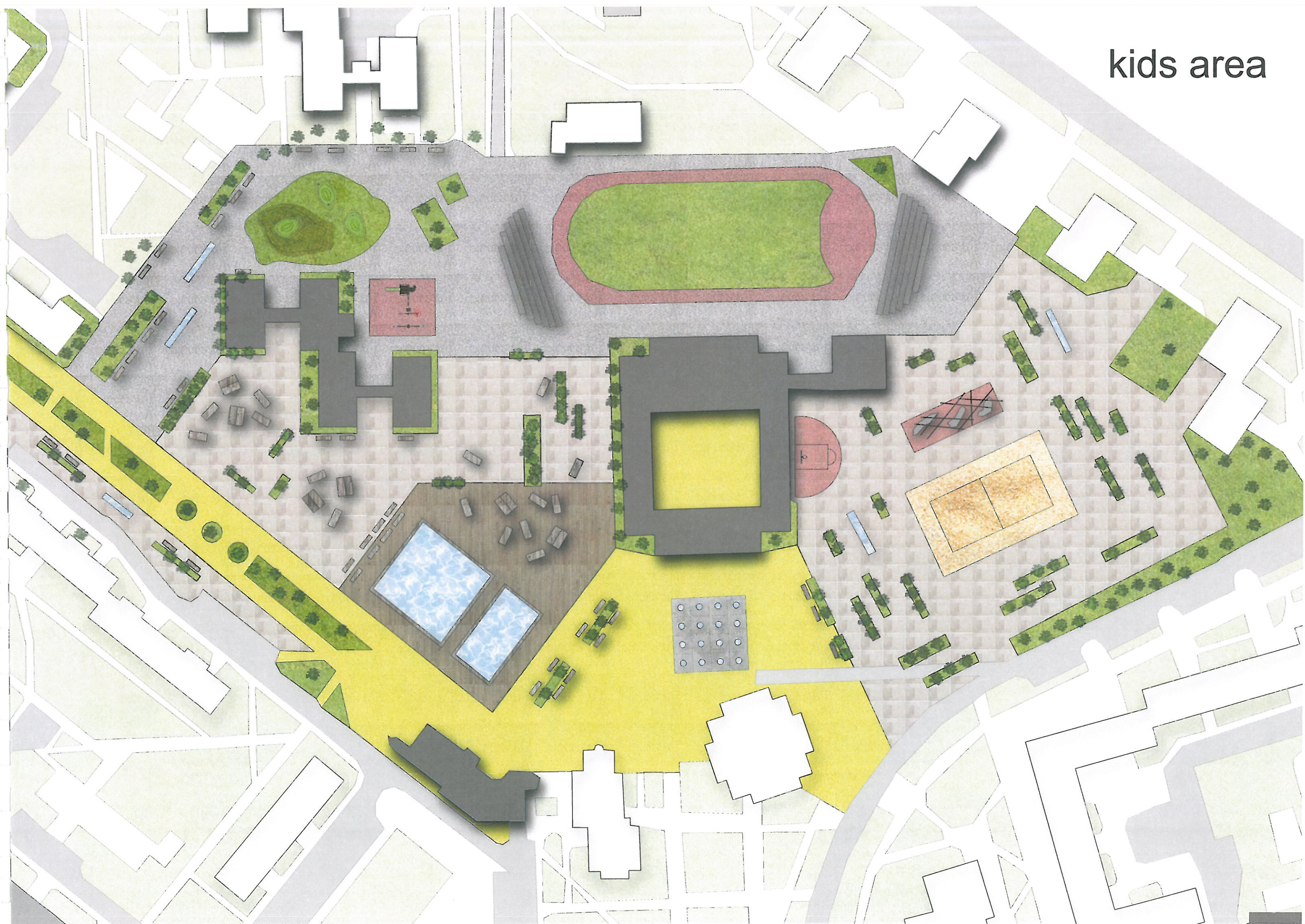

new areas

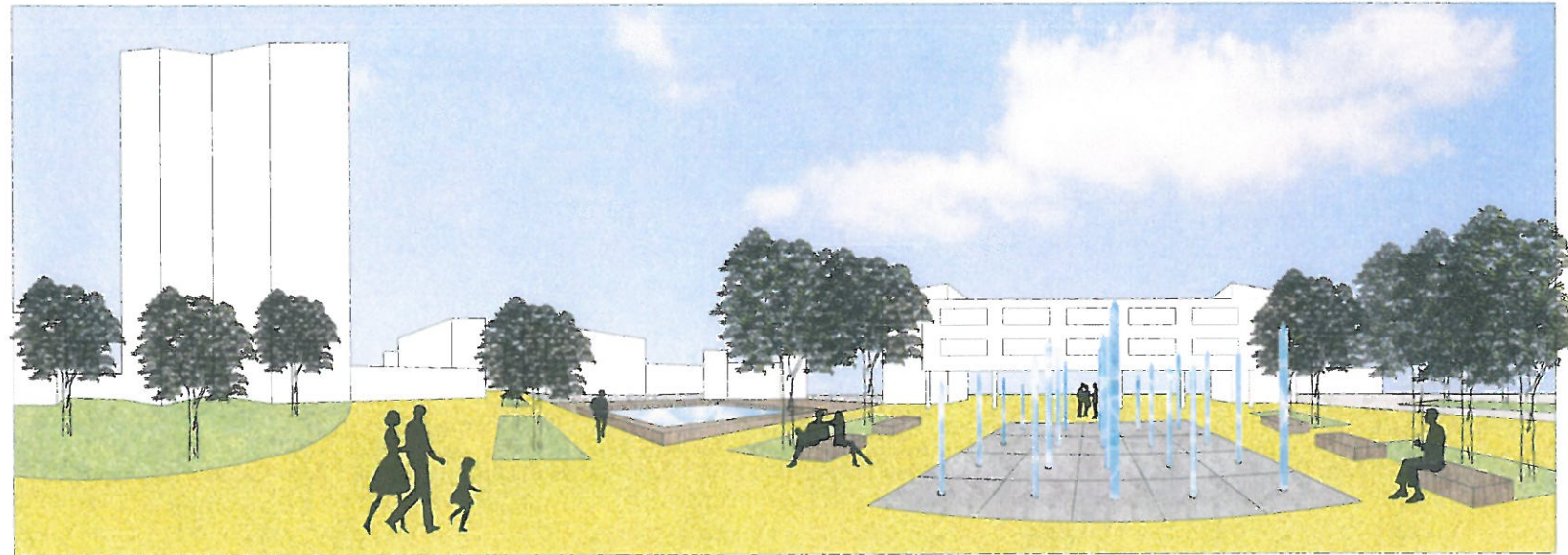

kids area
main square





boulevard
art area

