

## Model Photos





# Conceptual Collage



# Introduction to the location



Lviv is a city in western Ukraine, around 70 kilometers from the border with Poland. Traces of its Polish and Austro-Hungarian heritage are evident in its architecture. Lviv is the largest city in western Ukraine, with a population of 755 800 as of 2020. It is one of the main cultural centres of Ukraine.

The Persenkivka site is located in the southern part of Lviv, Ukraine. Its surroundings include living (apartment buildings), the new IT park, as well as an industrial zone, the Lviv Bus Plant, which is no longer in use. There are two borderlines of the site, the Stryiska Street on the east and the Persenkivka Street on the north. Of great importance is the Railroad (parallel with Persenkivka St.), together with the Persenkivka Train Station. This points out that this would be a prominent location. In our design we take these facts into consideration and try to relate the space to the importance of its surroundings. Our goal is to

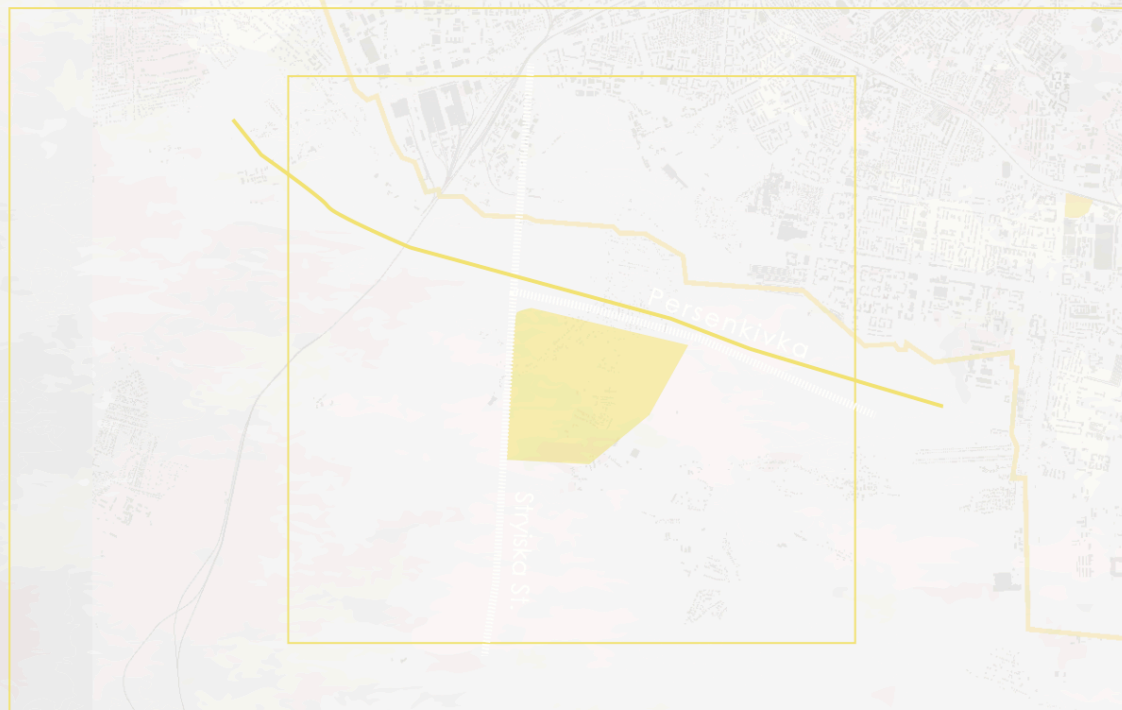



# Site Analysis

TRAM/BUS LINE

RAILWAY

STREETS

PUBLIC SPACE

BUILDING IN THE SITE

WATER

POTENTIALS

green network connection

increase productivity

cycling network

become an attraction

improve every-day life

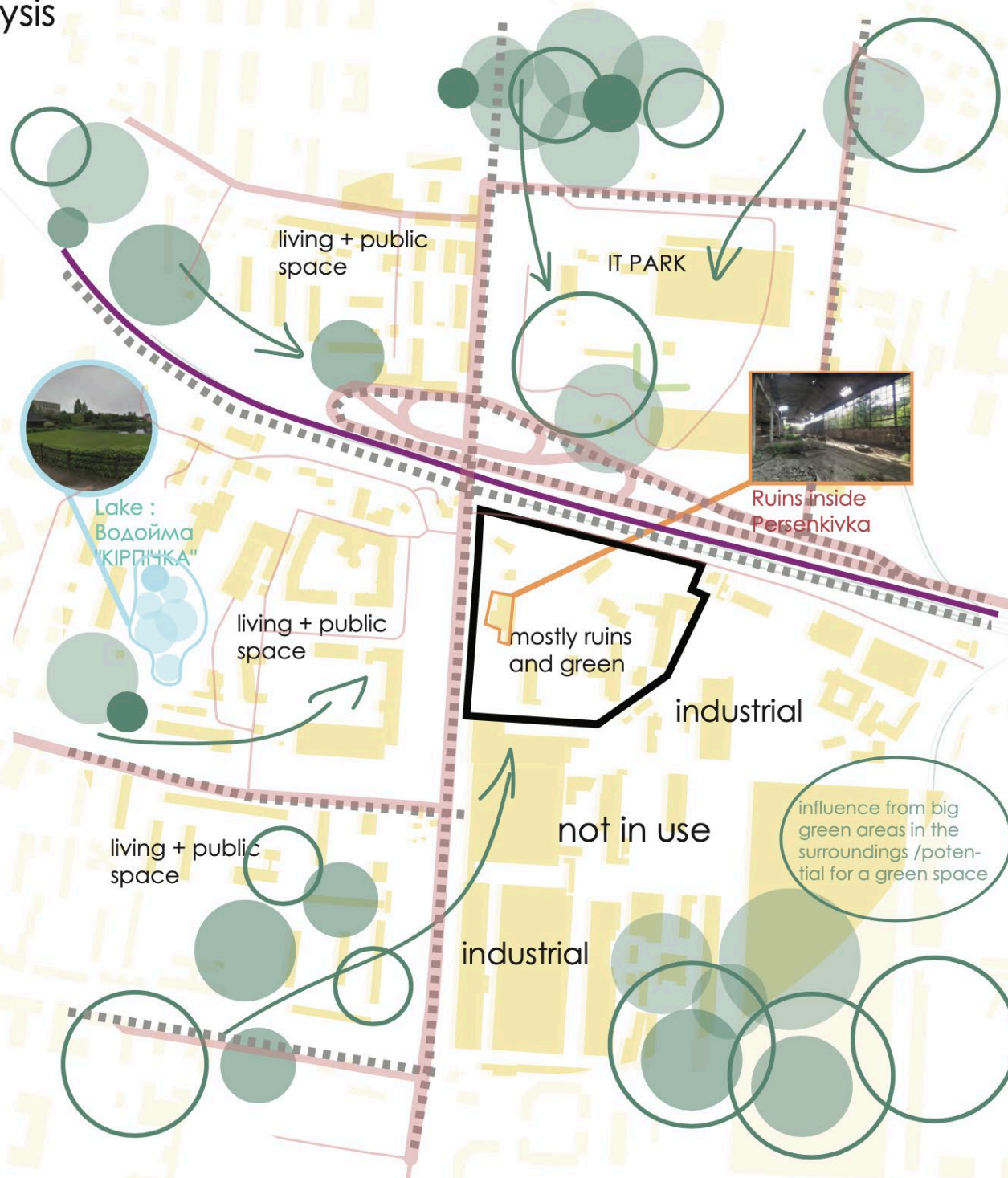

## LIVING AND LEISURE

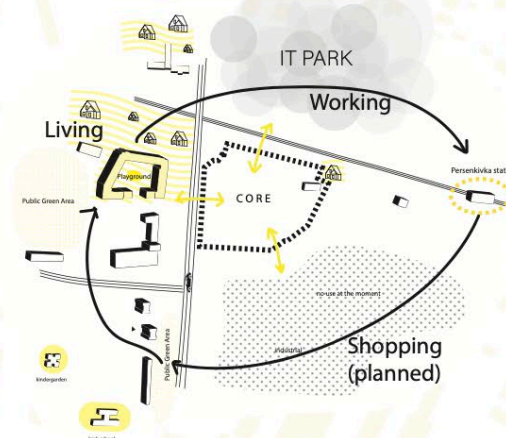

## TRAFFIC

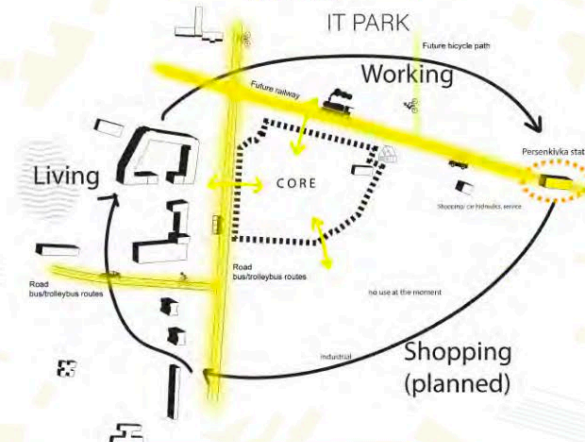

## BUSINESS AND CREATIVE

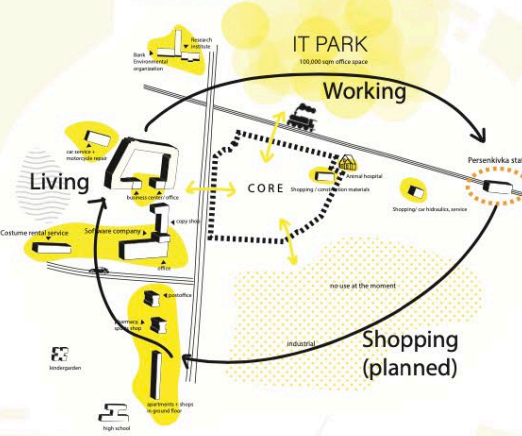



# Site Analysis

1 Cycling network , connecting Persenkivka with Academic buildings

2 Transport connection from Persenkivka to specific locations



## Network of Green Space





## GOALS

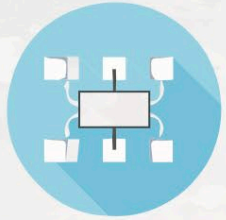

Accessibility



Productivity



Pedestrian oriented

## Conceptual Steps

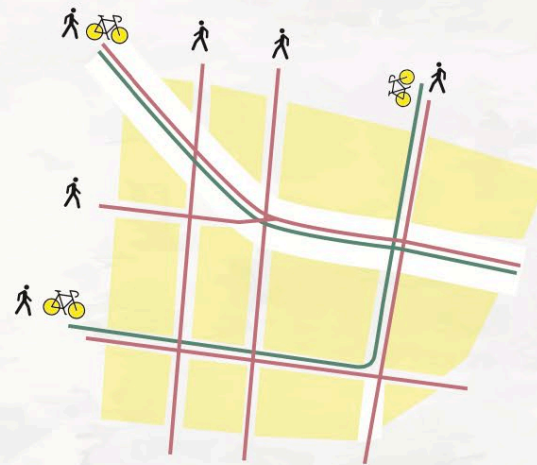

1. developing paths / pedestrian and bicycle



2. green network



3. diverse blocks organisation

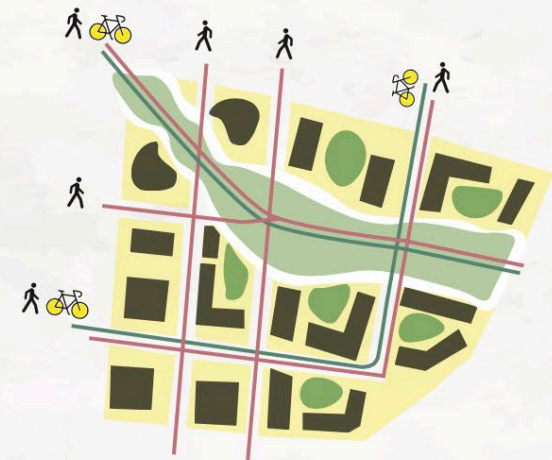

4. concept diagramm



# URBAN DESIGN PLAN

## FUNCTIONS



Offices



Workshops



Cultural activities



Active life



Living



Urban Farming



Markets

TRAIN STATION

BUSINESS CENTRE

BUSINESS CENTRE

OFFICE

OFFICE

OFFICE LIVING

LIVING

OFFICE COMMERCE

OFFICE COMMERCE

LIBRARY EXHIBITION

WORK SHOPS

YOUTH CENTRE

LIVING

LIVING

PARKING

SPORTS CENTRE

LIVING

LIVING

0 10 20 50 100



# Ground floor organisation

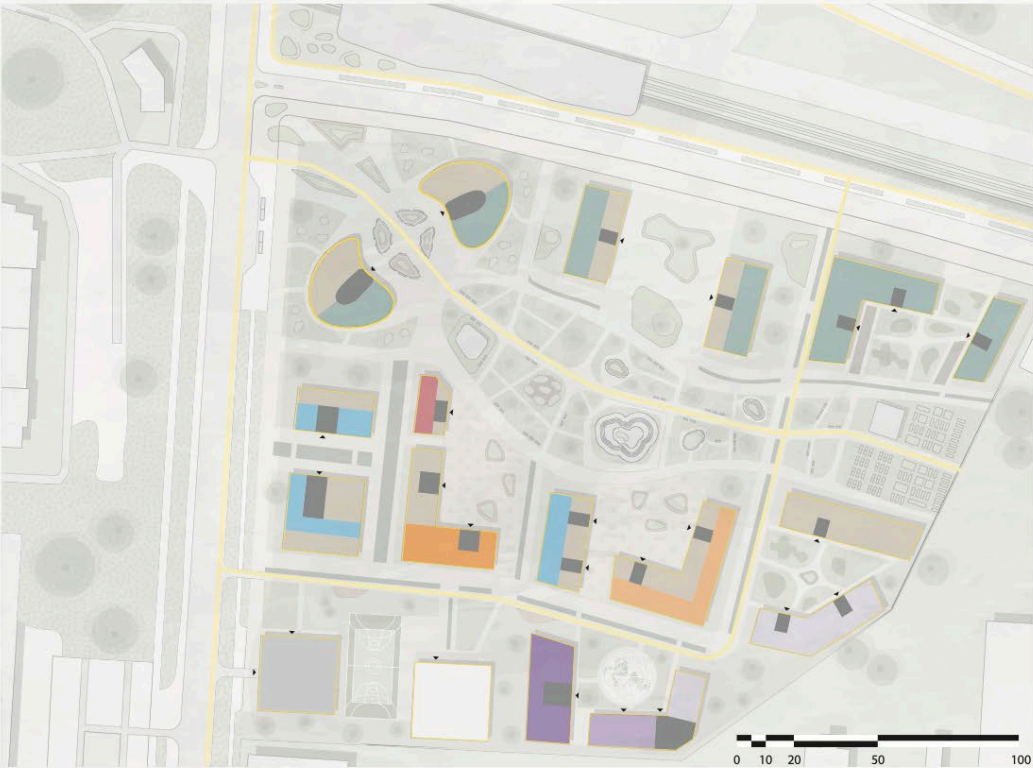

- |                                       |                      |
|---------------------------------------|----------------------|
| Cafes/ Restaurants/ Gardens           | Library              |
| Construction core (Erschließungskern) | Kindergarten         |
| Office/ Work area                     | Closed Playgrounds   |
| Shops                                 | Private Hangout area |
| Exhibitions Space                     | Garage               |
| Workshops/ Courses                    | Sports Centre        |

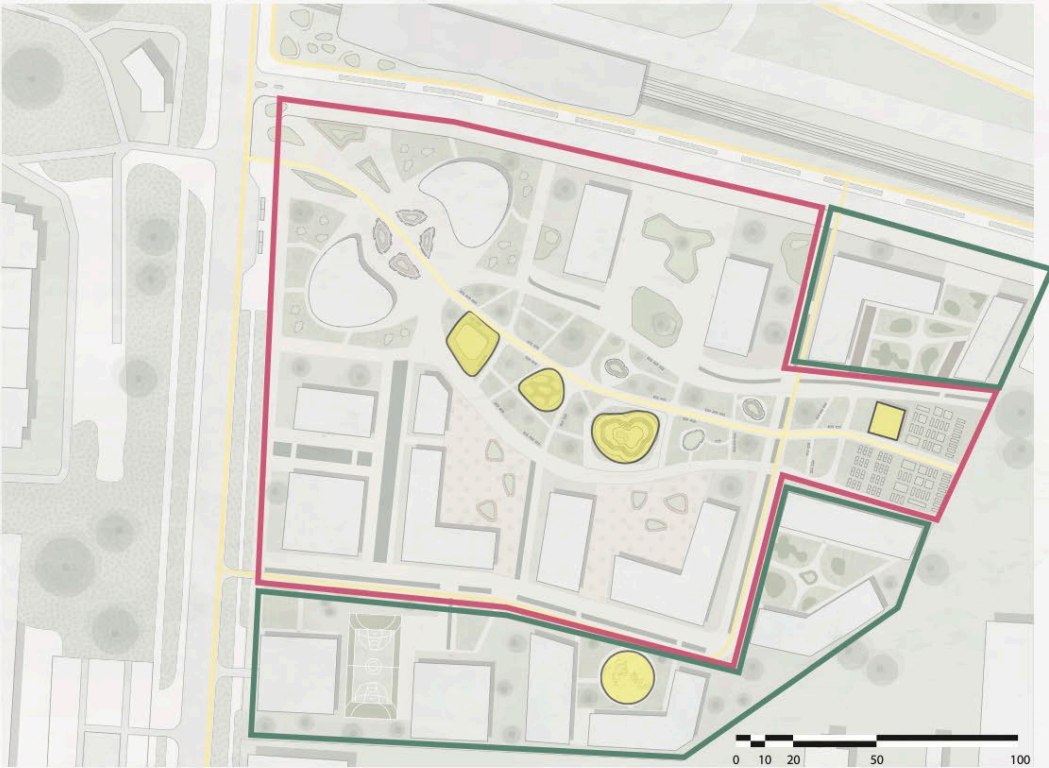

- |                   |   |
|-------------------|---|
| Activation points |   |
| Busy / Quiet Zone | / |
| Bicycle line      |   |



# MAGNET / CENTRAL PUBLIC SPACE

TRAIN STATION

BUSINESS  
CENTRE

RESTAURANT  
+ OFFICE

LIVING +  
OFFICE

COMMERCIAL  
+ OFFICE

LIBRARY  
+ EXHIBITION

YOUTH  
CENTRE

LIVING

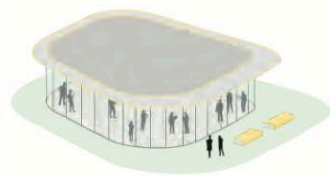

1 event venue



2 shading/recreation

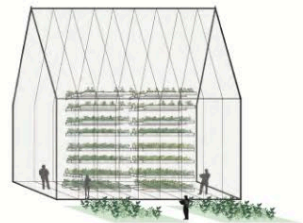

3 urban farming



4 skate park



# SUB - PROJECT 1 / Business center and mobility

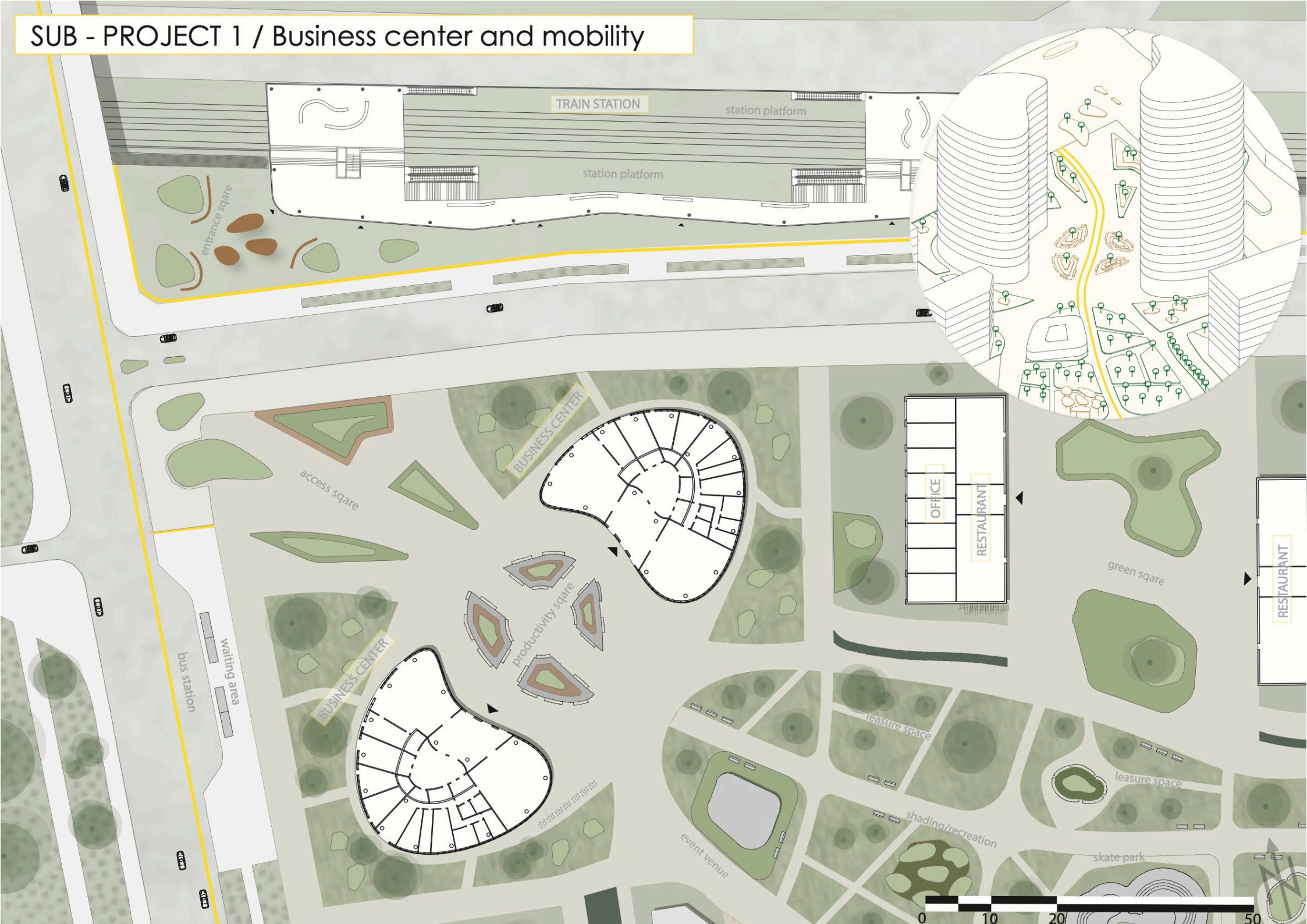



# SUB - PROJECT 2 / Urban farming + living + office





# Axonometry

## Surrounding and Section

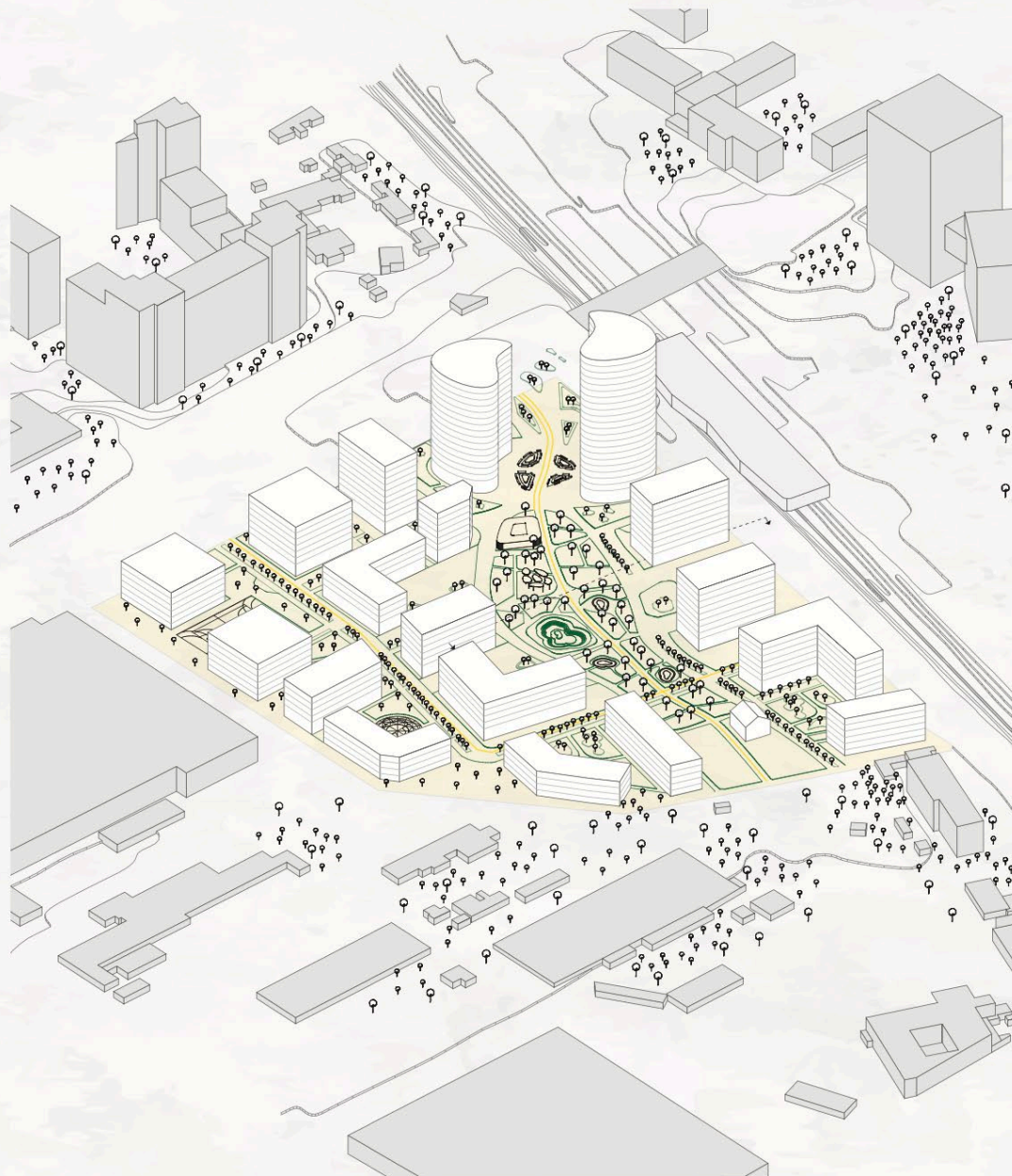



# Axonometry

## Facts & Functions

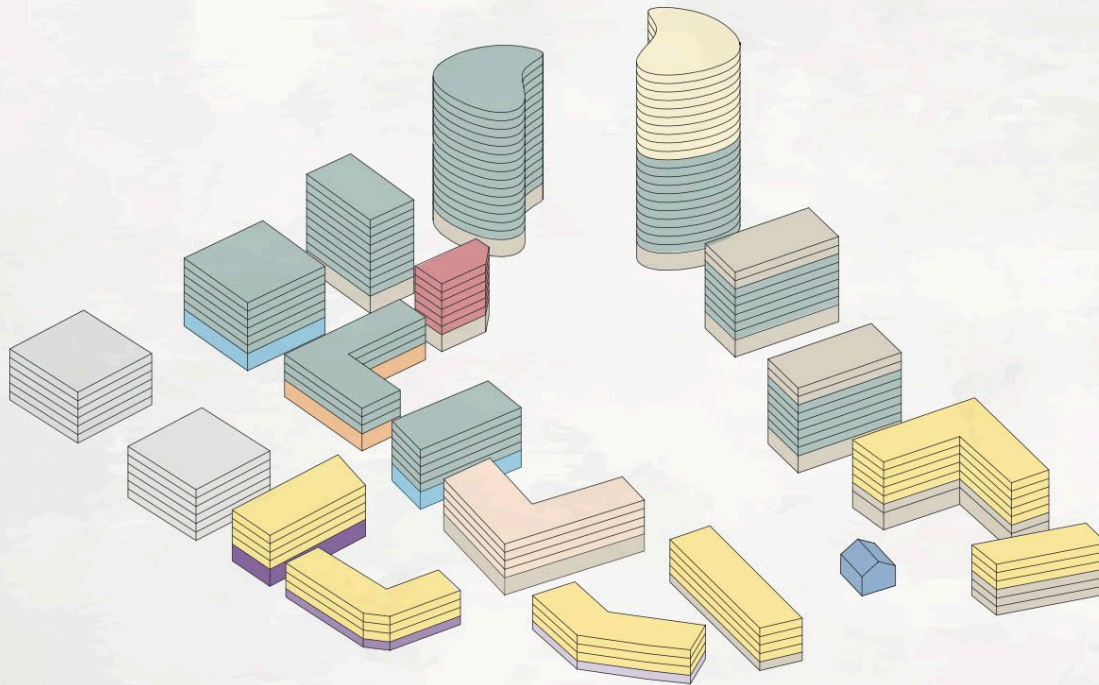
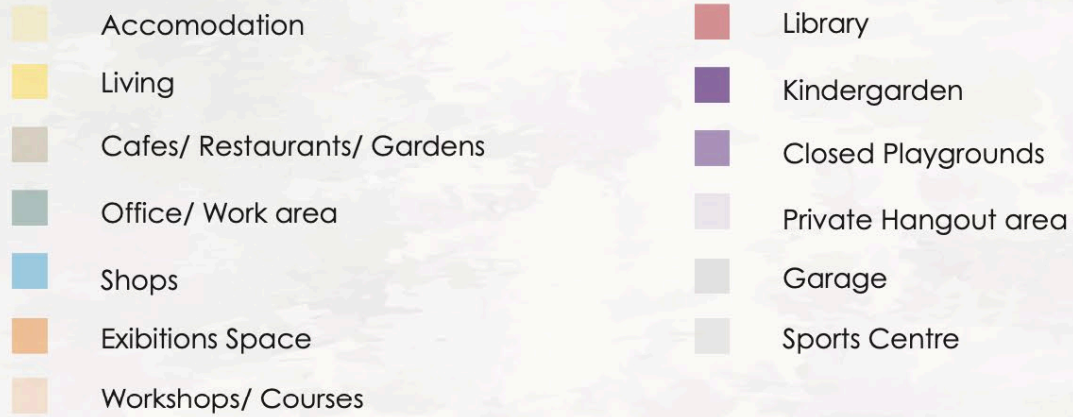

GFA: 93.062 m<sup>2</sup>

Office: 40.507 m<sup>2</sup>

Living: 24.109 m<sup>2</sup>

Public Functions: 20.925 m<sup>2</sup>

Parking: 5.106 m<sup>2</sup>

### People

Working: 3375 (12 m<sup>2</sup>/🧑)

Living: 964 (55 m<sup>2</sup>/🧑🧑)



Visual 1: Magnet





Visual 2: Public Space (Business Centre)

